

# Notice of Licensing Sub-Committee

Date: Wednesday, 10 December 2025 at 10.15 am

Venue: HMS Phoebe, BCP Civic Centre, Bournemouth BH2 6DY



---

## Membership:

Cllr D A Flagg

Cllr P Hilliard

Cllr M Howell

## Reserves:

Cllr C Matthews (1)

Cllr A Filer (2)

---

All Members of the Licensing Sub-Committee are summoned to attend this meeting to consider the items of business set out on the agenda below.

The press and public are welcome to view the live stream of this meeting at the following link:

<https://democracy.bcpCouncil.gov.uk/ieListDocuments.aspx?MIId=5883>

If you would like any further information on the items to be considered at the meeting please contact: Sinead O'Callaghan on 01202 128814 or email [democratic.services@bcpCouncil.gov.uk](mailto:democratic.services@bcpCouncil.gov.uk)

Press enquiries should be directed to the Press Office: Tel: 01202 118686 or email [press.office@bcpCouncil.gov.uk](mailto:press.office@bcpCouncil.gov.uk)

This notice and all the papers mentioned within it are available at [democracy.bcpCouncil.gov.uk](https://democracy.bcpCouncil.gov.uk)

AIDAN DUNN  
CHIEF EXECUTIVE

2 December 2025

**DEBATE**  
**NOT HATE**



Available online and  
on the Mod.gov app



## Maintaining and promoting high standards of conduct

### Declaring interests at meetings

Familiarise yourself with the Councillor Code of Conduct which can be found in Part 6 of the Council's Constitution.

Before the meeting, read the agenda and reports to see if the matters to be discussed at the meeting concern your interests

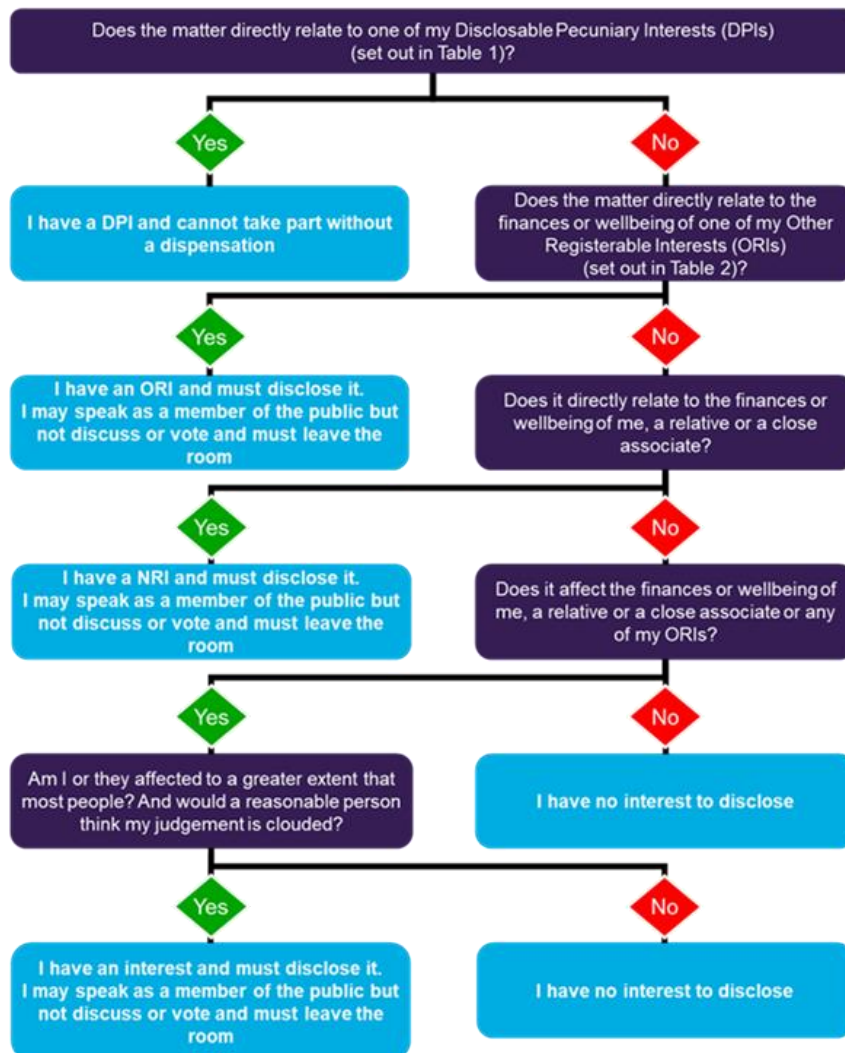

What are the principles of bias and pre-determination and how do they affect my participation in the meeting?

Bias and predetermination are common law concepts. If they affect you, your participation in the meeting may call into question the decision arrived at on the item.

#### Bias Test

In all the circumstances, would it lead a fair minded and informed observer to conclude that there was a real possibility or a real danger that the decision maker was biased?

#### Predetermination Test

At the time of making the decision, did the decision maker have a closed mind?

If a councillor appears to be biased or to have predetermined their decision, they must NOT participate in the meeting.

For more information or advice please contact the Monitoring Officer

### Selflessness

Councillors should act solely in terms of the public interest

### Integrity

Councillors must avoid placing themselves under any obligation to people or organisations that might try inappropriately to influence them in their work. They should not act or take decisions in order to gain financial or other material benefits for themselves, their family, or their friends. They must declare and resolve any interests and relationships

### Objectivity

Councillors must act and take decisions impartially, fairly and on merit, using the best evidence and without discrimination or bias

### Accountability

Councillors are accountable to the public for their decisions and actions and must submit themselves to the scrutiny necessary to ensure this

### Openness

Councillors should act and take decisions in an open and transparent manner. Information should not be withheld from the public unless there are clear and lawful reasons for so doing

### Honesty & Integrity

Councillors should act with honesty and integrity and should not place themselves in situations where their honesty and integrity may be questioned

### Leadership

Councillors should exhibit these principles in their own behaviour. They should actively promote and robustly support the principles and be willing to challenge poor behaviour wherever it occurs

# AGENDA

Items to be considered while the meeting is open to the public

**1. Election of Chair**

To elect a Chair of this meeting of the Licensing Sub-Committee.

**2. Apologies**

To receive any apologies for absence from Members.

**3. Declarations of Interests**

Councillors are requested to declare any interests on items included in this agenda. Please refer to the workflow on the preceding page for guidance.

Declarations received will be reported at the meeting.

**4. Protocol for Public Speaking at Licensing Hearings**

5 - 10

The protocol for public speaking at Licensing Sub Committee hearings is included with the agenda sheet for noting.

**5. Fiveways, 423 Charminster Road, Bournemouth**

11 - 64

Marston's Plc have made an application to vary the premises licence for Fiveways, 423 Charminster Road, Bournemouth. The application is made to request the following changes:-

- Change the internal and external layout of the premises due to refurbishment of the premises.
- Extend hours for supply of alcohol, regulated entertainment and late-night refreshment until 01:00 on Friday and Saturday and until 00:00 on Sunday.
- Add films (indoors and outdoors) and indoor sporting events from 10:00 to 00:00 on Sunday to Thursday and 10:00 to 01:00 on Friday and Saturday.
- Add a further condition to further promote the protection of children from harm licensing objective.

This matter is brought to the Licensing Sub Committee for determination.

No other items of business can be considered unless the Chair decides the matter is urgent for reasons that must be specified and recorded in the Minutes.

This page is intentionally left blank



## **LICENSING COMMITTEE AND SUB COMMITTEE – PROTOCOL FOR PUBLIC SPEAKING**

### **1. Introduction**

- 1.1 This protocol for public speaking applies to Licensing Committee and Sub Committee hearings in relation to matters including the licensing of alcohol, regulated entertainment, late night refreshment, gambling, sex establishments and hackney carriage and private hire drivers, vehicles and operators, as set out in Part 3.3 of the Council's Constitution.
- 1.2 These matters are considered in accordance with relevant legislation and associated regulations including the Licensing Act 2003 (as amended by the Police Reform and Social Responsibility Act 2011), the Gambling Act 2005, Part II and Schedule 3 of the Local Government (Miscellaneous Provisions) Act 1982 (as amended by Section 27 of the Policing and Crime Act 2009) and the Local Government (Miscellaneous Provisions) Act 1976.

### **2. Conduct of Hearings**

- 2.1 Chair welcomes everyone, matters of general housekeeping are dealt with, notification that the hearing may be recorded for live and subsequent broadcast on the Council's website, reminder to switch mobile phones to silent, etc.
- 2.2 Chair asks everyone present to introduce themselves and state their role.
- 2.3 Chair checks that all persons who have given notice of their intention to speak and any person who wishes to withdraw a representation or wishes not to speak have been identified.
- 2.4 Chair explains proposed procedure and order of speaking for hearing as set out in Appendix A or B of this protocol as appropriate. All parties confirm agreement or make representations on procedure proposed.
- 2.5 Licensing Officer's report is presented.
- 2.6 Parties speak in the order agreed.
- 2.7 With the exception of hackney carriage and private hire hearings, parties who are speaking should not repeat the information which they have already given in writing in their representation. They will be able to expand on the written information given, provided the information remains relevant. Any additional information should be limited to the grounds of their representation(s). For example, if they are objecting on the grounds of Public Nuisance, then they should confine their comments to matters relating to Public Nuisance.

- 2.8 Members of the Licensing Committee or Sub Committee may ask questions after each party has spoken and once all parties have spoken. Parties will be allowed to ask questions through the Chair.
- 2.9 Once all parties have been heard, the parties will be given the opportunity to sum up. Party who spoke first to go last. The hearing will then conclude.
- 2.10 Members will deliberate in private with the clerk and legal representative as appropriate present.
- 2.11 The decision will be taken by the Committee and notification of the decision will be given as follows:
  - 2.11.1 For Licensing Act 2003 and Gambling Act 2005 hearings, determination must be within the period of five working days beginning with the day or the last day on which the hearing was held in accordance with the relevant Regulations, unless otherwise specified (for example, the issuing of a counter notice following objection to a TEN, in which case the determination must be at the conclusion of the hearing).
  - 2.11.2 For Sex Establishment and other hearings, where possible determination will be within the period of five working days beginning with the day or the last day on which the hearing was held.
  - 2.11.3 For Hackney Carriage and Private Hire hearings, notification of the decision will be given at the conclusion of the hearing, followed by a written decision letter where possible within the period of five working days beginning with the day or the last day on which the hearing was held.
- 2.12 Notification of the decision will include information for all parties of any right of appeal as appropriate.

### **3 General points**

- 3.1 Hearings convened under the Licensing Act 2003 and the Gambling Act 2005 and associated regulations may be held remotely as required, if the Chairman agrees it is expedient to do so in the circumstances.
- 3.2 The hearing may be adjourned at any time at the discretion of the Members.
- 3.3 Members may amend the procedure at any time if they consider it to be in the public interest or in the interest of a fair hearing.
- 3.4 The Sub Committee may decide to conduct all or part of a hearing in non-public session in accordance with the relevant Regulations and/or where exempt information is likely to be disclosed.

- 3.5 The Chair may exclude any person from a hearing for being disruptive.
- 3.6 Meetings of the Licensing Committee in public session are recorded by the Council for live and subsequent broadcast on its website.
- 3.7 The hearing will take the form of a discussion.
- 3.8 Only persons (or their representatives) who have made an application, are subject to an application or have submitted a written representation or objection to the Licensing Authority under the relevant Act are permitted to speak at the hearing.
- 3.9 Any further information to support an application, representation, objection or notice (as applicable) can be submitted before the hearing. It may only be submitted at the hearing with the consent of all parties in accordance with any relevant Regulations. Wherever possible the Licensing Authority encourages parties to submit information at the earliest opportunity to allow sufficient time for this to be considered before the hearing and avoid the need for adjournment.
- 3.10 If a party has informed the Authority that they do not intend to participate, or be represented at the hearing, or has failed to advise whether they intend to participate or not, the hearing may proceed in their absence.
- 3.11 For other matters which are the responsibility of the Licensing Committee and not included in this protocol, the Meeting Procedure Rules in Part 4D of the Council's Constitution in relation to public questions, statements and petitions shall apply. This includes such matters as making recommendations on relevant licensing policies, approving the level of fees charged by the Council, and making decisions on tariffs charged by the Public Carriage Trade.
- 3.12 The Council's Constitution can be accessed using the following link:  
<https://democracy.bcpccouncil.gov.uk/ieListMeetings.aspx?CommitteeID=151&Info=1&bcr=1>

For further information please contact [democratic.services@bcpcouncil.gov.uk](mailto:democratic.services@bcpcouncil.gov.uk)

## Appendix A

### **Proposed procedure and order of speaking for hearings (other than hackney carriage and private hire hearings)**

1. The Licensing Officer presents report.
2. Questions of the Licensing Officer on their report. Members of the Sub-Committee to go first, then the applicant/licence holder.
3. Applicant will make their Application.
4. Questions of the Applicant by all parties, Members of the Committee/Sub-Committee to go first.
5. Responsible Authorities and Other Persons will make their representations.
6. Questions of the Responsible Authorities and Other Persons. Members of the Committee/Sub-Committee to go first.
7. All parties will be given an opportunity to sum up (with the party who spoke last to go first). The hearing will then conclude.
8. Sub-Committee will deliberate in private with Legal Adviser and Clerk present. (Councillors new to Licensing may observe but will not take part in the decision making).
9. Notification of the Sub Committee's decision will be given in accordance with the requirements of the Licensing Act and Gambling Act regulations. For other hearings, where possible determination will be within the period of five working days beginning with the day or the last day on which the hearing was held.
10. The notification of decision will include information about the right of appeal as appropriate.

## Appendix B

### **Proposed procedure and order of speaking for Hackney Carriage and Private Hire hearings**

1. The Licensing Officer presents their report.
2. Questions of the Licensing Officer on their report. Members of the Sub-Committee to go first, then the applicant/licence holder.
3. Applicant/licence holder presents their case.
4. Questions of the applicant/licence holder by all parties, Members of the Committee/Sub-Committee to go first.
5. All parties will be given an opportunity to sum up (with the party who spoke last to go first). The Hearing will then conclude.
6. Sub-Committee will deliberate in private with Legal Adviser and Clerk present. (Councillors new to Licensing may observe deliberations but will not take part in the decision making).
7. Notification of the decision will be given following deliberations at the conclusion of the hearing, to be followed by a written decision letter where possible within the period of five working days beginning with the day or the last day on which the hearing was held.
8. The Legal Adviser will advise parties of any right of appeal as appropriate at the conclusion of the Hearing. Information about the right of appeal as appropriate will also be included in the written decision letter.

Adopted by the Licensing Committee on 7.12.23



This page is intentionally left blank

## LICENSING SUB-COMMITTEE



Report subject	<b>10.12.25 - Fiveways, 423 Charminster Road, Bournemouth</b>
Meeting date	10 December 2025
Status	Public Report
Executive summary	<p>Marston's Plc have made an application to vary the premises licence for Fiveways, 423 Charminster Road, Bournemouth.</p> <p>The application is made to request the following changes:-</p> <ul style="list-style-type: none"> <li>• Change the internal and external layout of the premises due to refurbishment of the premises.</li> <li>• Extend hours for supply of alcohol, regulated entertainment and late-night refreshment until 01:00 on Friday and Saturday and until 00:00 on Sunday.</li> <li>• Add films (indoors and outdoors) and indoor sporting events from 10:00 to 00:00 on Sunday to Thursday and 10:00 to 01:00 on Friday and Saturday.</li> <li>• Add a further condition to further promote the protection of children from harm licensing objective.</li> </ul>
Recommendations	<p><b>It is RECOMMENDED that:</b></p> <p><b>Members are asked to decide whether to: -</b></p> <p><b>a) Grant the application for variation as made;</b></p> <p><b>b) Refuse the application, or part of, for variation to the premises licence;</b></p> <p><b>c) Grant the application, or part of, subject to additional conditions.</b></p> <p><b>Members of the Licensing Sub-Committee are asked to make a decision at the end of the hearing after all relevant parties have been given the opportunity to speak.</b></p> <p><b>Members must give full reasons for their decision.</b></p>
Reason for recommendations	<p>The Licensing Authority has received 21 representations and a petition containing 23 signatures against the application on the grounds that to grant the application would undermine the prevention of crime and disorder, prevention of public nuisance, public safety and the protection of children from harm licensing</p>

	<p>objectives.</p> <p>The Licensing Authority may only consider aspects relevant to the application that have been raised in the representations.</p> <p>Where representations have been received from a responsible authority or any other person, and the concerns have not been resolved through mediation between all parties, the Scheme of Delegation, set out in the Council's Constitution states that the application should be dealt with by the Licensing Sub-Committee.</p>
--	-----------------------------------------------------------------------------------------------------------------------------------------------------------------------------------------------------------------------------------------------------------------------------------------------------------------------------------------------------------------------------------------------------------------------------------------------------------------------------------------

Portfolio Holder(s):	Councillor Kieron Wilson – Housing and Regulatory Services
Corporate Director	Glynn Barton – Wellbeing
Report Authors	Sarah Rogers – Principal Licensing Officer
Wards	Winton East
Classification	For Decision

## Background

1. The application to vary the premises licence, under Section 34 of the Licensing Act 2003, was made by Marston's plc on 22 October 2025. A copy of the application is attached at Appendix 1.
2. A plan showing the location of the premises is attached at Appendix 2.
3. The premises have held a premises licence, issued under the Licensing Act 2003, since 25 November 2005 when the licence was converted from the previous Justices' Liquor Licence under the 1964 Act. A copy of the current premises licence is attached at Appendix 3.
4. Following receipt of representations, the application was amended to request that regulated entertainment and films be restricted to 23:00 hours but with a retention of the proposed licensable activity of retail sale of alcohol midweek until 23:00 hours and on Friday and Saturday until 12 midnight.
5. This amendment resulted in one representation being withdrawn.
6. The application also offered to implement a Noise Management Plan.

## Consultation

7. The application was served on all responsible authorities and the applicant confirmed that the statutory notices were displayed on the premises and published in the local newspaper.
8. Environmental Health have made representation as a responsible authority and there have been 20 representations made by other persons and a petition with 23 signatures against the application.
9. A copy of the representations are attached at Appendix 4
10. Dorset Police have agreed the following conditions, which will be imposed on the licence, should the application be granted:-
  - a) SIA door supervisors shall be provided for the period of one hour before and until one hour after the undertaking of England Football Tournament games, further the premises licence holder shall conduct a written risk assessment to determine the need for door staff during any high risk events, a copy of which shall be made available for inspection by a Police officer and shall deploy door supervisors in

accordance with the outcome of the risk assessment. In any event a minimum of 2 SIA will be employed from 20.00 on New Years Eve until the close of business.

- b) Any person working at the premises in a security capacity shall clearly display his or her name badge at all times whilst on duty and shall wear high visibility arm bands.
- c) Polycarbonate/plastic drink ware is to be used by all persons during any high risk events, all alcoholic and 'soft' drinks are to be decanted by premises staff into such drink ware at the point of sale.

11. No other representations were received from any of the other responsible authorities.

### **Options Appraisal**

12. Before making a decision, Members are asked to consider the following matters: -

- The representations made by Environmental Health and other persons.
- The conditions agreed with Dorset Police.
- The submissions made by or made on behalf of the applicant.
- All four licensing objectives are relevant to this application namely the prevention of crime and disorder, public safety, prevention of public nuisance and protection of children from harm.
- The Licensing Act 2003, Regulations and Guidance.
- BCP Council's Statement of Licensing Policy in particular Section 12 which deals with the licensing objective of the prevention of public nuisance. Paragraphs 12.5 and 12.6 highlight factors which should be considered and paragraphs 12.9 and 12.10 deal with outside areas and how they are expected to be managed.

### **Summary of financial implications**

13. An appeal may be made against the decision of Members by the applicant or any person making a representation to the Magistrates' Court which could have a financial impact on the Council.

### **Summary of legal implications**

14. If Members decide to refuse the application or attach conditions to the licence which the applicant does not agree to, the applicant may appeal to the Magistrates' Court within a period of 21 days beginning with the day that the applicant is notified, in writing, of the decision.

### **Summary of human resources implications**

15. There are no human resources implications.

### **Summary of sustainability impact**

16. There are no sustainability impact implications.



### **Summary of public health implications**

17. There are no public health implications.

### **Summary of equality implications**

18. There are no equality implications.

### **Summary of risk assessment**

19. There is no requirement for a risk assessment.

### **Background papers**

**BCP Council – Statement of Licensing Policy**

[Statement of licensing policy | BCP](#)

### **Hearing Regulations**

[The Licensing Act 2003 \(Hearings\) Regulations 2005](#)

**Revised Guidance issued under Section 182 of the Licensing Act 2003 (February 2025)**

[Revised guidance issued under section 182 of the Licensing Act 2003 \(February 2025\) \(accessible version\) - GOV.UK](#)

### **Appendices**

1 – Copy Application

2 – Location Plan

3 – Current Premises Licence

4 – Representations Received

This page is intentionally left blank

## Application to vary a premises licence under the Licensing Act 2003

### PLEASE READ THE FOLLOWING INSTRUCTIONS FIRST

Before completing this form please read the guidance notes at the end of the form. If you are completing this form by hand please write legibly in block capitals. In all cases ensure that your answers are inside the boxes and written in black ink. Use additional sheets if necessary.

You may wish to keep a copy of the completed form for your records.

**We Marston's PLC being the premises licence holder, apply to vary a premises licence under section 34 of the Licensing Act 2003 for the premises described in Part 1 below.**

#### Premises Licence Number

BH084378

#### Part 1 – Premises details

Postal address of premises or, if none, ordnance survey map reference or description

Fiveways, 423 Charminster Road,

Post town  
Bournemouth

Post code  
BH8 9QY

Telephone number of premises (if any)

Non-domestic rateable value of premises

£47,500

#### Part 2 – Applicant Details

Daytime contact telephone number

C/O 01142 668664

Email address  
(optional)

Current postal  
address if  
different from  
premises address

St Johns House, St Johns Square, , Wolverhampton, , WV2 4BH

Post Town

Wolverhampton

Postcode

WV2 4BH

### Part 3 – Variation

Do you want the proposed variation to have effect as soon as possible?

Please tick ☒ yes



If not do you want the variation to take effect from

Day Month Year

--	--	--	--	--	--	--	--

If your proposed variation would mean that 5,000 or more people are expected to attend the premises at any one time, please state the number expected to attend.

N/A

Do you want the proposed variation to have effect in relation to the introduction of the late night levy?

(Please see Guidance Note 1)

yes ☐ no ☒

#### Please describe briefly the nature of the proposed variation (please read guidance note 2)

Application is made to vary the Premises Licence for the Fiveways.

The premises is to have a significant refurbishment which addresses updating both the interior and exterior of the premises in anticipation for the property being relaunched under the Marston's brand of Grandstand.

As the name indicates the brand is focussed around the provision of sporting events both nationally and locally whilst retaining a strong food offer and being attractive to a wide range of the community including families and females. The premises will have two new dedicated menus and will seek become more fundamentally involved within the local community by way of championing local amateur teams.

This will provide a significant enhancement to the overall operation of the premises.

Application is therefore made to vary the Premises Licence in respect of three elements which are as follows:

##### 1. Layout

Application is made to amend the plan annexed to the Premises Licence as per drawing JMDA 1826/04/001A a copy of which is attached and as follows:

##### Internally

- The removal of a partition
- Installation of new bench seating to the games area.
- Installation of new booth seating adjacent to the ladies toilet.
- Relocation of Gaming machines
- Appropriate redecoration throughout.

##### Externally

- To licence external areas being front patio and beer garden:  
Sunday to Thursday until 23:00 hours  
Friday and Saturday until 12 midnight.
- To include temporary external bar location to be utilised at peak times so as to provide additional supervision to external area.

##### 2. Licensable activities.

- (a) Application is made to extend the hours in relation to the existing licensable activities retail sale of alcohol, regulated entertainment and late night refreshment. Such extension is limited to Friday and Saturday when the proposed hours are 11:00 until 01:00 hours and to permit Sunday until 00:00 hours.
- (b) Application is made to add licensable activities of films (indoors and outdoors) and indoor sporting events Sunday to Thursday 11:00 to 00:00 hours and Friday and Saturday 11:00 until 01:00 hours
- (c) Opening hours.

A consequential amendment to opening hours is sought so as to permit the premises to be open on Friday and Saturdays until 01:30 hours.

##### 3. Conditions

The application has allowed an opportunity for the conditions endorsed upon the Licence to be reviewed. It is proposed that the following condition should be added:

Children under the age of 16 shall not be permitted entry to the premises after 22:00 hours unless accompanied by an adult, attending a pre-booked function or dining.

It is considered that the amendments in conjunction with the refurbishment will continue to promote the four licensing objectives.

## Part 4 Operating Schedule

Please complete those parts of the Operating Schedule below which would be subject to change if this application to vary is successful.

Please tick ✓ yes

### **Provision of regulated entertainment** (Please see guidance note 3)

- |                                                                                                             |                                     |
|-------------------------------------------------------------------------------------------------------------|-------------------------------------|
| a) Plays (if ticking yes, fill in box A)                                                                    | <input type="checkbox"/>            |
| b) Films (if ticking yes, fill in box B)                                                                    | <input checked="" type="checkbox"/> |
| c) indoor sporting events (if ticking yes, fill in box C)                                                   | <input checked="" type="checkbox"/> |
| d) boxing or wrestling entertainment (if ticking yes, fill in box D)                                        | <input type="checkbox"/>            |
| e) live music (if ticking yes, fill in box E)                                                               | <input checked="" type="checkbox"/> |
| f) recorded music (if ticking yes, fill in box F)                                                           | <input checked="" type="checkbox"/> |
| g) performances of dance (if ticking yes, fill in box G)                                                    | <input checked="" type="checkbox"/> |
| h) anything of a similar description to that falling within (e), (f) or (g) (if ticking yes, fill in box H) | <input type="checkbox"/>            |

**Provision of late night refreshment** (if ticking yes, fill in box I) ☒

**Sale by retail of alcohol** (if ticking yes, fill in box J) ☒

**In all cases complete boxes K, L and M**



# A

<b>Plays</b> Standard days and timings (please read guidance note 8)			<b>Will the performance of a play take place indoors or outdoors or both – please tick {Y}</b> (please read guidance note 4).	Indoors	
Day	Start	Finish		Outdoors	
				Both	
Mon				<b>Please give further details here</b> (please read guidance note 5)	
Tue					
Wed					
Thur			<b>State any seasonal variations for performing plays</b> (please read guidance note 6)		
Fri					
Sat					
Sun			<b>Non standard timings. Where you intend to use the premises for the performance of plays at different times to those listed in the column on the left, please list</b> (please read guidance note 7)		

# B

<b>Films</b> Standard days and timings (please read guidance note 8)			<b>Will the exhibition of films take place indoors or outdoors or both – please tick {Y}</b> (please read guidance note 4).	Indoors	
Day	Start	Finish		Outdoors	
				Both	
Mon	11:00	00:00		<b>Please give further details here</b> (please read guidance note 5)  External area limited to Sunday to Thursday until 23:00 hours Friday and Saturday until 12 midnight	
Tue	11:00	00:00			
Wed	11:00	00:00			
Thur	11:00	00:00	<b>State any seasonal variations for the exhibition of films</b> (please read guidance note 6)		
Fri	11:00	01:00			
Sat	11:00	01:00			
Sun	11:00	00:00	<b>Non standard timings. Where you intend to use the premises for the exhibition of films at different times to those listed in the column on the left, please list</b> (please read guidance note 7)  To be extended when times for alcohol are extended by way of non standard timing		

# C

<b>Indoor sporting events</b> Standard days and timings (please read guidance note 8)			<b><u>Please give further details</u></b> (please read guidance note 5)
Day	Start	Finish	External area limited to  Sunday to Thursday until 23:00 hours Friday and Saturday until 12 midnight
Mon	11:00	00:00	
Tue	11:00	00:00	<b><u>Non standard timings. Where you intend to use the premises for indoor sporting events at different times to those listed in the column on the left, please list</u></b> (please read guidance note 7)  To be extended when times for alcohol are extended by way of non standard timing
Wed	11:00	00:00	
Thur	11:00	00:00	
Fri	11:00	01:00	
Sat	11:00	01:00	
Sun	11:00	00:00	

# D

<b>Boxing or wrestling entertainment</b> Standard days and timings (please read guidance note 8)			<b><u>Will the boxing or wrestling entertainment take place indoors or outdoors or both – please tick {Y}</u></b> (please read guidance note 4).	Indoors	
Day	Start	Finish		Outdoors	
Mon				<b><u>Please give further details here</u></b> (please read guidance note 5)	Both
Tue			<b><u>State any seasonal variations for boxing or wrestling entertainment</u></b> (please read guidance note 6)		
Wed					
Thur			<b><u>Non standard timings. Where you intend to use the premises for boxing or wrestling entertainment at different times to those listed in the column on the left, please list</u></b> (please read guidance note 7)		
Fri					
Sat					
Sun					

# E

<b>Live music</b> Standard days and timings (please read guidance note 8)			<b>Will the performance of live music take place indoors or outdoors or both – please tick {Y}</b> (please read guidance note 4).	Indoors	
				Outdoors	
				Both	✓
Day	Start	Finish	<b>Please give further details here</b> (please read guidance note 5)  External area limited to  Sunday to Thursday until 23:00 hours Friday and Saturday until 12 midnight		
Mon	As existing	As existing			
Tue	As existing	As existing	<b>State any seasonal variations for the performance of live music</b> (please read guidance note 6)		
Wed	As existing	As existing			
Thur	As existing	As existing	<b>Non standard timings. Where you intend to use the premises for the performance of live music at different times to those listed in the column on the left, please list</b> (please read guidance note 7)		
Fri	As existing	01:00			
Sat	As existing	01:00			
Sun	As existing	00:00			

# F

<b>Recorded music</b> Standard days and timings (please read guidance note 8)			<b>Will the playing of recorded music take place indoors or outdoors or both – please tick {Y}</b> (please read guidance note 4).	Indoors	
				Outdoors	
				Both	✓
Day	Start	Finish	<b>Please give further details here</b> (please read guidance note 5)  External area limited to  Sunday to Thursday until 23:00 hours Friday and Saturday until 12 midnight		
Mon	As existing	As existing			
Tue	As existing	As existing	<b>State any seasonal variations for playing recorded music</b> (please read guidance note 6)		
Wed	As existing	As existing			
Thur	As existing	As existing	<b>Non standard timings. Where you intend to use the premises for the playing of recorded music entertainment at different times to those listed in the column on the left, please list</b> (please read guidance note 7)		
Fri	As existing	01:00			
Sat	As existing	01:00			
Sun	As existing	00:00			



# G

<b>Performances of dance</b> Standard days and timings (please read guidance note 8)			<b>Will the performance of dance take place indoors or outdoors or both – please tick {Y}</b> (please read guidance note 4).	Indoors	✓
				Outdoors	
				Both	
Day	Start	Finish	<b>Please give further details here</b> (please read guidance note 5)		
Mon	As existing	As existing			
Tue	As existing	As existing			
Wed	As existing	As existing	<b>State any seasonal variations for the performance of dance</b> (please read guidance note 6)		
Thur	As existing	As existing			
Fri	As existing	01:00			
Sat	As existing	01:00	<b>Non standard timings. Where you intend to use the premises for the performance of dance entertainment at different times to those listed in the column on the left, please list</b> (please read guidance note 7)		
Sun	As existing	00:00			

# H

<b>Anything of a similar description to that falling within (e), (f) or (g)</b> Standard days and timings (please read guidance note 8)			<b>Please give a description of the type of entertainment you will be providing</b>		
Day	Start	Finish	<b>Will this entertainment take place indoors or outdoors or both – please tick {Y}</b> (please read guidance note 4).	Indoors	
Mon				Outdoors	
Tue				Both	
Wed			<b>Please give further details here</b> (please read guidance note 5)		
Thur					
Fri					
Sat			<b>State any seasonal variations for entertainment of a similar description to that falling within (e), (f) or (g)</b> (please read guidance note 6)		
Sun					
			<b>Non standard timings. Where you intend to use the premises for the entertainment of similar description to that falling within (e), (f) or (g) at different times to those listed in the column on the left, please list</b> (please read guidance note 7)		

# I

Late night refreshment			<u>Will the provision of late night refreshment take place indoors or outdoors or both – please tick {Y}</u> (please read guidance note 4).	Indoors	
Day	Start	Finish		Outdoors	
				Both	✓
Mon	As existing	As existing	<u>Please give further details here</u> (please read guidance note 5)  External area limited to		
Tue	As existing	As existing	Sunday to Thursday until 23:00 hours Friday and Saturday until 12 midnight		
Wed	As existing	As existing	<u>State any seasonal variations for the provision of late night refreshment</u> (please read guidance note 6)		
Thur	As existing	As existing			
Fri	As existing	01:00	<u>Non standard timings. Where you intend to use the premises for the provision of late night refreshment at different times, to those listed in the column on the left, please list</u> (please read guidance note 7)		
Sat	As existing	01:00			
Sun	As existing	00:00			

J

<b>Supply of alcohol</b> Standard days and timings (please read guidance note 8)			<b>Will the supply of alcohol be for consumption</b> (Please tick box <input checked="" type="checkbox"/> ) (please read guidance note 9)	On the premises Off the premises Both	<input type="checkbox"/> <input type="checkbox"/> <input checked="" type="checkbox"/>
Day	Start	Finish	<b>State any seasonal variations for the supply of alcohol</b> (please read guidance note 6) External area limited to Sunday to Thursday until 23:00 hours Friday and Saturday until 12 midnight		
Mon	11:00	00:00			
Tue	11:00	00:00			
Wed	11:00	00:00			
Thur	11:00	00:00			
Fri	11:00	01:00	<b>Non-standard timings. Where you intend to use the premises for the supply of alcohol at different times to those listed in the column on the left, please list</b> (please read guidance note 7) No change to non standard timings		
Sat	11:00	01:00			
Sun	11:00	00:00			

## K

**Please highlight any adult entertainment or services, activities, other entertainment or matters ancillary to the use of the premises that may give rise to concern in respect of children (please read guidance note 10)**



**L**

<b>Hours premises are open to the public</b> Standard days and timings (please read guidance note 8)			<b>State any seasonal variation</b> (please read guidance note 6)
Day	Start	Finish	
Mon	10:00	00:30	<b>Non standard timings. Where you intend to use the premises to be open to the public at different times from those listed in the column on the left, please list</b> (please read guidance note 7)
Tue	10:00	00:30	
Wed	10:00	00:30	
Thur	10:00	00:30	
Fri	10:00	01:30	
Sat	10:00	01:30	
Sun	11:00	00:30	

**Please identify those conditions currently imposed on the licence which you believe could be removed as a consequence of the proposed variation you are seeking**

Please tick ✓ yes

I have enclosed the premises licence	<input checked="" type="checkbox"/>	If you have not ticked one of these boxes please fill in reasons for not including the licence, or part of it, below
I have enclosed the relevant part of the premises licence	<input checked="" type="checkbox"/>	

Reasons why I have failed to enclose the premises licence or relevant part of premises licence

## M

Describe any additional steps you intend to take to promote the four licensing objectives as a result of the proposed variation:

### a) General – all four licensing objectives (b,c,d,e) (please read guidance note 11)

The works are to facilitate the change to Grandstand and are part of a significant refurbishment. The external areas have historically been used. A small increase to hours of operation is sought but it is not anticipated this will impact on the four licensing objectives.

The above is provided by way of explanation and is not proposed to be added as a condition.

### b) The prevention of crime and disorder

No new conditions are proposed.

### c) Public safety

No new conditions are proposed

### d) The prevention of public nuisance

No new conditions are proposed

### e) The protection of children from harm

An additional condition is proposed:

Children under the age of 16 shall not be permitted entry to the premises after 22:00 hours unless accompanied by an adult, attending a pre-booked function or dining.

- I have made or enclosed payment of the fee; or ☒
- I have not made or enclosed payment of the fee because this application has been made in relation to the introduction of the late night levy. ☐
- I have sent copies of this application and the plan to responsible authorities and others where applicable ☒
- I understand that I must now advertise my application ☒
- I have enclosed the premises licence or relevant part of it or explanation ☒
- I understand that if I do not comply with the above requirements my application will be rejected ☒

**IT IS AN OFFENCE, UNDER SECTION 158 OF THE LICENSING ACT 2003, TO MAKE A FALSE STATEMENT IN OR IN CONNECTION WITH THIS APPLICATION. THOSE WHO MAKE A FALSE STATEMENT MAY BE LIABLE ON SUMMARY CONVICTION TO A FINE OF ANY AMOUNT.**

## Part 5 – Signatures (please read guidance note 12)

**Signature of applicant (the current premises licence holder) or applicant's solicitor or other duly authorised agent.** (Please read guidance note 13). **If signing on behalf of the applicant please state in what capacity.**

Signature: John Gaunt & Partners .....

Date: 22/10/22 .....

Capacity: Solicitors .....

**Where the premises licence is jointly held signature of 2<sup>nd</sup> applicant (the current premises licence holder) or 2<sup>nd</sup> applicant's solicitor or other authorised agent.** (Please read guidance note 14). **If signing on behalf of the applicant please state in what capacity.**

Signature: John Gaunt & Partners .....

Date: .....

Capacity: Solicitors .....

**Contact name (where not previously given) and address for correspondence associated with this application (please read guidance note 15)**

John Gaunt & Partners  
Omega Court  
372 Cemetery Road

**Post town**  
Sheffield

**Post code**  
S11 8FT

**Telephone number (if any)**  
[REDACTED]

**If you would prefer us to correspond with you by email your email address (optional)**  
[REDACTED]

## Notes for Guidance

**This application cannot be used to vary the licence so as to extend the period for which the licence has effect or to vary substantially the premises to which it relates. If you wish to make that type of change to the premises licence, you should make a new premises licence application under section 17 of the Licensing Act 2003.**

1. You do not have to pay a fee if the only purpose of the variation for which you are applying is to avoid becoming liable for the late night levy
2. Describe the premises. For example, the type of premises, its general situation and layout and any other information which could be relevant to the licensing objectives. Where your application includes off-supplies of alcohol and you intend to provide a place of consumption of these off-supplies of alcohol, you must include a description of where the place will be and its proximity to the premises.
3. In terms of specific regulated entertainments please note that:
  - Plays: no licence is required for performances between 08.00 and 23.00 on any day, provided that the audience does not exceed 500.
  - Films: no licence is required for 'not-for-profit' film exhibition held in community premises between 08.00 and 23.00 on any day provided that the audience does not exceed 500 and the organiser (a) gets consent to the screening from a person who is responsible for the premises; and (b) ensures that each such screening abides by age classification ratings.
  - Indoor sporting events: no licence is required for performances between 08.00 and 23.00 on any day, provided that the audience does not exceed 1000.
  - Boxing or Wrestling Entertainment: no licence is required for a contest, exhibition or display of Greco-Roman wrestling, or freestyle wrestling between 08.00 and 23.00 on any day, provided that the audience does not exceed 1000. Combined fighting sports – defined as a contest, exhibition or display which combines boxing or wrestling with one or more martial arts – are licensable as a boxing or wrestling entertainment rather than an indoor sporting event.
  - Live music: no licence permission is required for:
    - a performance of unamplified live music between 08.00 and 23.00 on any day, on any premises.
    - a performance of amplified live music between 08.00 and 23.00 on any day on premises authorised to sell alcohol for consumption on those premises, provided that the audience does not exceed 500.
    - a performance of amplified live music between 08.00 and 23.00 on any day, in a workplace that is not licensed to sell alcohol on those premises, provided that the audience does not exceed 500.
    - a performance of amplified live music between 08.00 and 23.00 on any day, in a church hall, village hall, community hall, or other similar community premises, that is not licensed by a premises licence to sell alcohol, provided that (a) the audience does not exceed 500, and (b) the organiser gets consent for the performance from a person who is responsible for the premises.
    - a performance of amplified live music between 08.00 and 23.00 on any day, at the non-residential premises of (i) a local authority, or (ii) a school, or (iii) a hospital, provided that (a) the audience does not exceed 500, and (b) the organiser gets consent for the performance on the relevant premises from: (i) the local authority concerned, or (ii) the school or (iii) the health care provider for the hospital.
  - Recorded Music: no licence permission is required for:
    - any playing of recorded music between 08.00 and 23.00 on any day on premises authorised to sell alcohol for consumption on those premises, provided that the audience does not exceed 500.
    - any playing of recorded music between 08.00 and 23.00 on any day, in a church hall, village hall, community hall, or other similar community premises, that is not licensed by a premises licence to sell alcohol, provided that (a) the audience does not exceed 500, and (b) the organiser gets consent for the performance from a person who is responsible for the premises.
    - any playing of recorded music between 08.00 and 23.00 on any day, at the non-residential premises of (i) a local authority, or (ii) a school, or (iii) a hospital, provided that (a) the audience does not exceed 500, and (b) the organiser gets consent for the performance on the relevant premises from: (i) the local authority concerned, or (ii) the school proprietor or (iii) the health care provider for the hospital.



- Dance: no licence is required for performances between 08.00 and 23.00 on any day, provided that the audience does not exceed 500. However, a performance which amounts to adult entertainment remains licensable.
  - Cross activity exemptions: no licence is required between 08.00 and 23.00 on any day, with no limit on audience size for:
    - any entertainment taking place on the premises of the local authority where the entertainment is provided by or on behalf of the local authority;
    - any entertainment taking place on the hospital premises of the health care provider where the entertainment is provided by or on behalf of the health care provider;
    - any entertainment taking place on the premises of the school where the entertainment is provided by or on behalf of the school proprietor; and
    - any entertainment (excluding films and a boxing or wrestling entertainment) taking place at a travelling circus, provided that (a) it takes place within a moveable structure that accommodates the audience, and (b) that the travelling circus has not been located on the same site for more than 28 consecutive days.
4. Where taking place in a building or other structure please tick as appropriate (indoors may include a tent).
  5. For example state type of activity to be authorised, if not already stated, and give relevant further details, for example (but not exclusively) whether or not music will be amplified or unamplified.
  6. For example (but not exclusively), where the activity will occur on additional days during the summer months.
  7. For example (but not exclusively), where you wish the activity to go on longer on a particular day e.g. Christmas Eve.
  8. Please give timings in 24 hour clock (e.g. 16.00) and only give details for the days of the week when you intend the premises to be used for the activity.
  9. If you wish people to be able to consume alcohol on the premises, please tick 'on the premises'. If you wish people to be able to purchase alcohol to consume away from the premises, please tick 'off the premises'. If you wish people to be able to do both, please tick 'both'.
  10. Please give information about anything intended to occur at the premises or ancillary to the use of the premises which may give rise to concern in respect of children regardless of whether you intend children to have access to the premises, for example (but not exclusively) nudity or semi-nudity, films for restricted age groups or the presence of gaming machines.
  11. Please list here steps you will take to promote all four licensing objectives together.
  12. The application form must be signed.
  13. An applicant's agent (for example solicitor) may sign the form on their behalf provided that they have actual authority to do so.
  14. Where there is more than one applicant, each of the applicants or their respective agents must sign the application form.
  15. This is the address which we shall use to correspond with you about this application.



This page is intentionally left blank

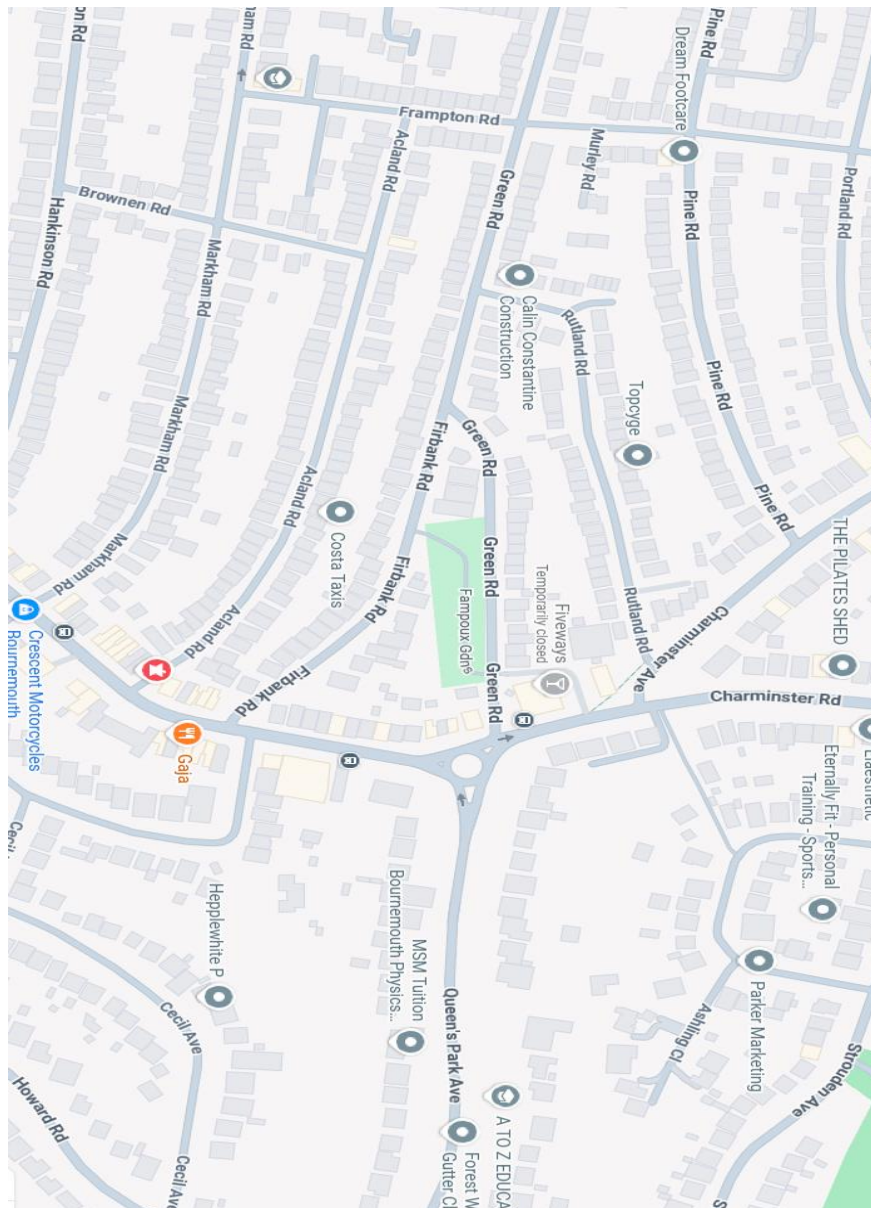

Fiveways 423 Charminster Road Bournemouth

This page is intentionally left blank



## Premises Licence Part A

Premises licence number: BH084378

Postal address of premises, or if none, ordnance survey map reference or description:	
Fiveways 423 Charminster Road	
<b>Post town:</b> Bournemouth	<b>Post Code:</b> BH8 9QY
<b>Telephone number:</b> 01202 549673	

Licensable activities authorised by the licence:
Live Music Recorded Music Performances of Dance Activity like Music / Dance Late Night Refreshment Supply of Alcohol

The times the licence authorises the carrying out of licensable activities:
<p><b>Live Music</b>  Monday - 10:00 to 00:00  Tuesday - 10:00 to 00:00  Wednesday - 10:00 to 00:00  Thursday - 10:00 to 00:00  Friday - 10:00 to 00:00  Saturday - 10:00 to 00:00  Sunday - 11:00 to 23:00  Performance of live music will take place indoors.</p> <p><b>Recorded Music</b>  Monday - 10:00 to 00:00  Tuesday - 10:00 to 00:00  Wednesday - 10:00 to 00:00  Thursday - 10:00 to 00:00  Friday - 10:00 to 00:00  Saturday - 10:00 to 00:00  Sunday - 11:00 to 23:00  Playing of recorded music will take place indoors.</p> <p><b>Performances of Dance</b>  Monday - 10:00 to 00:00  Tuesday - 10:00 to 00:00  Wednesday - 10:00 to 00:00  Thursday - 10:00 to 00:00  Friday - 10:00 to 00:00  Saturday - 10:00 to 00:00  Sunday - 11:00 to 23:00  Performance of dance will take place indoors.</p> <p><b>Activity like Music / Dance</b>  Monday - 10:00 to 00:00  Tuesday - 10:00 to 00:00  Wednesday - 10:00 to 00:00  Thursday - 10:00 to 00:00  Friday - 10:00 to 00:00  Saturday - 10:00 to 00:00  Sunday - 11:00 to 23:00  Entertainment will take place indoors.</p>

**Late Night Refreshment**

Monday - 23:00 to 00:00

Tuesday - 23:00 to 00:00

Wednesday - 23:00 to 00:00

Thursday - 23:00 to 00:00

Friday - 23:00 to 00:00

Saturday - 23:00 to 00:00

Provision of late night refreshments will take place indoors.

**Supply of Alcohol**

Monday - 11:00 to 00:00

Tuesday - 11:00 to 00:00

Wednesday - 11:00 to 00:00

Thursday - 11:00 to 00:00

Friday - 11:00 to 00:00

Saturday - 11:00 to 00:00

Sunday - 11:00 to 23:00

Non-standard timings for the supply of alcohol.

From 11:00 on New Year's Eve until 11:00 New Year's Day.

On each Thursday, Friday, Saturday and Monday of a Bank Holiday weekend until 01:00 and on each Sunday of such weekend until 00:00.

**The opening hours of the premises:**

Monday - 10:00 to 00:30

Tuesday - 10:00 to 00:30

Wednesday - 10:00 to 00:30

Thursday - 10:00 to 00:30

Friday - 10:00 to 00:30

Saturday - 10:00 to 00:30

Sunday - 11:00 to 23:30

Non-standard timings.

From 11:00 on New Year's Eve until 11:00 New Year's Day.

On each Thursday, Friday, Saturday and Monday of a Bank Holiday weekend until 01:00 and on each Sunday of such weekend until 00:00.

**Where the licence authorises supplies of alcohol whether these are on and/ or off supplies:**

Alcohol will be consumed on and off the premises

## Part 2

**Name, (registered) address, telephone number and email (where relevant) of holder of premises licence:**

Marston's Plc  
St Johns House  
St Johns Square  
Wolverhampton  
WV2 4BH

**Registered number of holder, for example company number, charity number (where applicable):**

00031461

**Name, address and telephone number of designated premises supervisor where the premises licence authorises the supply of alcohol:**

Mrs Hayley Connell

■■■■■■■■■■■■■■■■■■■■  
■■■■■■■■■■■■■■■■■■■■  
■■■■■■■■■■■■■■■■■■■■  
■■■■■■■■■■■■■■■■■■■■

**Personal licence number and issuing authority of personal licence held by designated premises supervisor where the premises licence authorises for the supply of alcohol:**

BH168238  
Bournemouth Borough Council

## Annex 1 – Mandatory conditions

### Mandatory Conditions (Sections 19,20,21 LA 2003)

- 1.1. There shall be no sale or supply of alcohol when there is no designated premises supervisor in respect of this premises licence or at a time when the said premises supervisor does not hold a personal licence or when his/her licence is suspended.
- 1.2. Every supply of alcohol under the premises licence must be made or authorised by a person who holds a personal licence.

### The Licensing Act 2003 (Mandatory Licensing Conditions) (Amendment) Order 2014

- 1.3.
  1. The responsible person must ensure that staff on relevant premises do not carry out, arrange or participate in any irresponsible promotions in relation to the premises.
  2. In this paragraph, an irresponsible promotion means any one or more of the following activities, or substantially similar activities, carried on for the purpose of encouraging the sale or supply of alcohol for consumption on the premises –
    - (a) games or other activities which require or encourage, or are designed to require or encourage, individuals to -
      - (i) drink a quantity of alcohol within a time limit (other than to drink alcohol sold or supplied on the premises before the cessation of the period in which the responsible person is authorised to sell or supply alcohol), or
      - (ii) drink as much alcohol as possible (whether within a time limit or otherwise);
    - (b) provision of unlimited or unspecified quantities of alcohol free or for a fixed or discounted fee to the public or to a group defined by a particular characteristic in a manner which carries a significant risk of undermining a licensing objective;
    - (c) provision of free or discounted alcohol or any other thing as a prize to encourage or reward the purchase and consumption of alcohol over a period of 24 hours or less in a manner which carries a significant risk of undermining a licensing objective;
    - (d) selling or supplying alcohol in association with promotional posters or flyers on, or in the vicinity of, the premises which can reasonably be considered to condone, encourage or glamorise anti- social behaviour or to refer to the effects of drunkenness in any favourable manner;
    - (e) dispensing alcohol directly by one person into the mouth of another (other than where that other person is unable to drink without assistance by reason of disability).
- 1.4. The responsible person must ensure that free potable water is provided on request to customers where it is reasonably available.
- 1.5.
  1. The premises licence holder or club premises certificate holder must ensure that an age verification policy is adopted in respect of the premises in relation to the sale or supply of alcohol.
  2. The designated premises supervisor in relation to the premises licence must ensure that the supply of alcohol at the premises is carried on in accordance with the age verification policy.
  3. The policy must require individuals who appear to the responsible person to be under 18 years of age (or such older age as may be specified in the policy) to produce on request,

before being served alcohol, identification bearing their photograph, date of birth and either -

- (a) a holographic mark, or
- (b) an ultraviolet feature.

1.6. The responsible person must ensure that -

- (a) where any of the following alcoholic drinks is sold or supplied for consumption on the premises (other than alcoholic drinks sold or supplied having been made up in advance ready for sale or supply in a securely closed container) it is available to customers in the following measures—
  - (i) beer or cider: ½ pint;
  - (ii) gin, rum, vodka or whisky: 25 ml or 35 ml; and
  - (iii) still wine in a glass: 125 ml;
- (b) these measures are displayed in a menu, price list or other printed material which is available to customers on the premises; and
- (c) where a customer does not in relation to a sale of alcohol specify the quantity of alcohol to be sold, the customer is made aware that these measures are available.

#### The Licensing Act 2003 (Mandatory Conditions) Order 2014

1.7.

1. A relevant person shall ensure that no alcohol is sold or supplied for consumption on or off the premises for a price which is less than the permitted price.
2. For the purposes of the condition set out in paragraph 1 -
  - (a) “duty” is to be construed in accordance with the Alcoholic Liquor Duties Act 1979;
  - (b) “permitted price” is the price found by applying the formula —

$$P = D + (D \times V)$$

Where –

- (i) P is the permitted price,
- (ii) D is the amount of duty chargeable in relation to the alcohol as if the duty were charged on the date of the sale or supply of the alcohol, and
- (iii) V is the rate of value added tax chargeable in relation to the alcohol as if the value added tax were charged on the date of the sale or supply of the alcohol;
- (c) “relevant person” means, in relation to premises in respect of which there is in force a premises licence -
  - (i) the holder of the premises licence,
  - (ii) the designated premises supervisor (if any) in respect of such a licence, or
  - (iii) the personal licence holder who makes or authorises a supply of alcohol under such a licence;

- (d) "relevant person" means, in relation to premises in respect of which there is in force a club premises certificate, any member or officer of the club present on the premises in a capacity which enables the member or officer to prevent the supply in question; and
  - (e) "value added tax" means value added tax charged in accordance with the Value Added Tax Act 1994.
3. Where the permitted price given by Paragraph (b) of paragraph 2 would (apart from this paragraph) not be a whole number of pennies, the price given by that sub-paragraph shall be taken to be the price actually given by that sub-paragraph rounded up to the nearest penny.
  4. (1) Sub-paragraph (2) applies where the permitted price given by Paragraph (b) of paragraph 2 on a day ("the first day") would be different from the permitted price on the next day ("the second day") as a result of a change to the rate of duty or value added tax.  
  
(2) The permitted price which would apply on the first day applies to sales or supplies of alcohol which take place before the expiry of the period of 14 days beginning on the second day.

Mandatory Conditions – (Embedded Restrictions) – Attached as part of Conversion Application under Transitional Grandfather Rights Restaurants/Hotels

- 1.8. The abovementioned restrictions on the times permitted to sell alcohol do not prohibit the supply to, or consumption by, any person of alcohol in any premises where they are residing.
- 1.9. The abovementioned restrictions on the times permitted to sell alcohol do not prohibit the sale of alcohol to a trader or club for the purposes of the trade or club.
- 1.10. The abovementioned restrictions on the times permitted to sell alcohol do not prohibit the ordering of alcohol to be consumed off the premises, or the despatch by the vendor of the alcohol so ordered.
- 1.11. The abovementioned restrictions on the times permitted to sell alcohol do not prohibit the taking of alcohol from the premises by a person residing there.
- 1.12. The abovementioned restrictions on the times permitted to sell alcohol do not prohibit the supply of alcohol for consumption on the premises to any private friends of a person residing there who are bona fide entertained by him at his own expense, or the consumption of persons so supplied.
- 1.13. The abovementioned restrictions on the times permitted to sell alcohol do not prohibit the supply of alcohol for consumption on premises to persons employed there for the purposes of the businesses carried on by the holder of the licence, or the consumption of liquor so supplied, if the liquor is supplied at the expense of their employer or of the person carrying on or in charge of the business on the premises.
- 1.14. The abovementioned restrictions on the times permitted to sell alcohol do not prohibit the sale or supply of alcohol to any canteen or mess, being a canteen in which the sale or supply of alcohol is carried out under the authority of the Secretary of State or an authorised mess of members of Her Majesty's naval, military or air forces.

## **Annex 2 – Conditions consistent with the operating schedule**

### Prevention of Crime and Disorder

- 2.1. 2.1 All staff involved in the sale of alcohol shall receive training on the law relating to prohibited sales, the age verification policy adopted by the premises and the conditions attaching to the premises licence.
  - 2.1.1 Refresher training shall be provided at least once every 12 months.
  - 2.1.2 A record shall be maintained of all staff training and that record shall be signed by the person receiving the training and the trainer. The records shall be kept for a minimum of 12 months and made available for inspection by Police, Licensing or other authorised officers.
- 2.2. An incident log shall be kept at the premises. The log shall include the date and time of the incident and the name of the member of staff who has been involved, and made available on request of an authorised officer of the Council or the Police, which shall record the following:-
  - (a) any incidents of disorder
  - (b) any faults in the CCTV system/or searching equipment/or scanning equipment
  - (c) any refusal of the sale of alcohol
  - (d) any visit by a relevant authority or emergency service
  - (e) all crimes reported to the venue
  - (f) all ejections of patrons
  - (g) all seizures of drugs or offensive weapons
  - 2.2.1 This log shall be checked on a weekly basis by the DPS of the premises.
- 2.3. A CCTV system shall be installed to cover all entry and exit points enabling frontal identification of every person entering in any light condition.
  - 2.3.1 The CCTV system shall continually record and cover areas where alcohol is kept for selection and purchase by the public whilst the premises is open for licensable activities. It shall operating during all times when customers remain on the premises.
  - 2.3.2 All recordings shall be stored for a minimum of 31 days with correct date and time stamping. Recordings shall be made available immediately upon request of Police or an authorised officer of the Council throughout the preceding 31 days period.
  - 2.3.3 The CCTV system shall be updated and maintained according to Police recommendations.
  - 2.3.4 A staff member from the premises who is conversant with the operation of the CCTV system shall be on the premises at all times when the premises are open to the public. This staff member must be able to show a Police or authorised Council Officer recent data or footage with the absolute minimum of delay when requested.
  - 2.3.5 CCTV shall be downloaded on request of the Police or authorised officer of the Council. Appropriate signage advising customers of CCTV being in operation shall be prominently displayed in the premises.
  - 2.3.6 A documented check of the CCTV shall be completed weekly to ensure all cameras remain operational and the 31 days storage for recordings is being maintained.
- 2.4. The premises shall maintain membership of the Town Watch scheme (or any successor scheme) a senior member of staff shall attend all Town Watch meetings unless an emergency arises preventing such attendance and the premises will support Town Watch initiatives.

### Prevention of Public Nuisance

- 2.5. Music shall be turned down to background level at least 30 minutes before closing time.
- 2.6. Windows shall be closed by 23:00.
- 2.7. A member of staff shall ask customers to leave quietly at closing time.
- 2.8. There shall be signs at exit reminding customers to leave quietly.

#### Protection of Children from Harm

- 2.9. Challenge 21 shall be operated at the premises where the only acceptable form of identification are (recognised photographic identification cards such as a driving licence or passport/holographically marked PASS scheme identification cards).

- 2.9.1 Appropriate signage advising customers of the policy shall prominently be displayed in the premises.

#### **Annex 3 – Conditions attached after a hearing by the licensing authority**

N/A

#### **Annex 4 – Plans**

This licence is issued in accordance with the plan M084378, dated 24 November 2005, as attached.



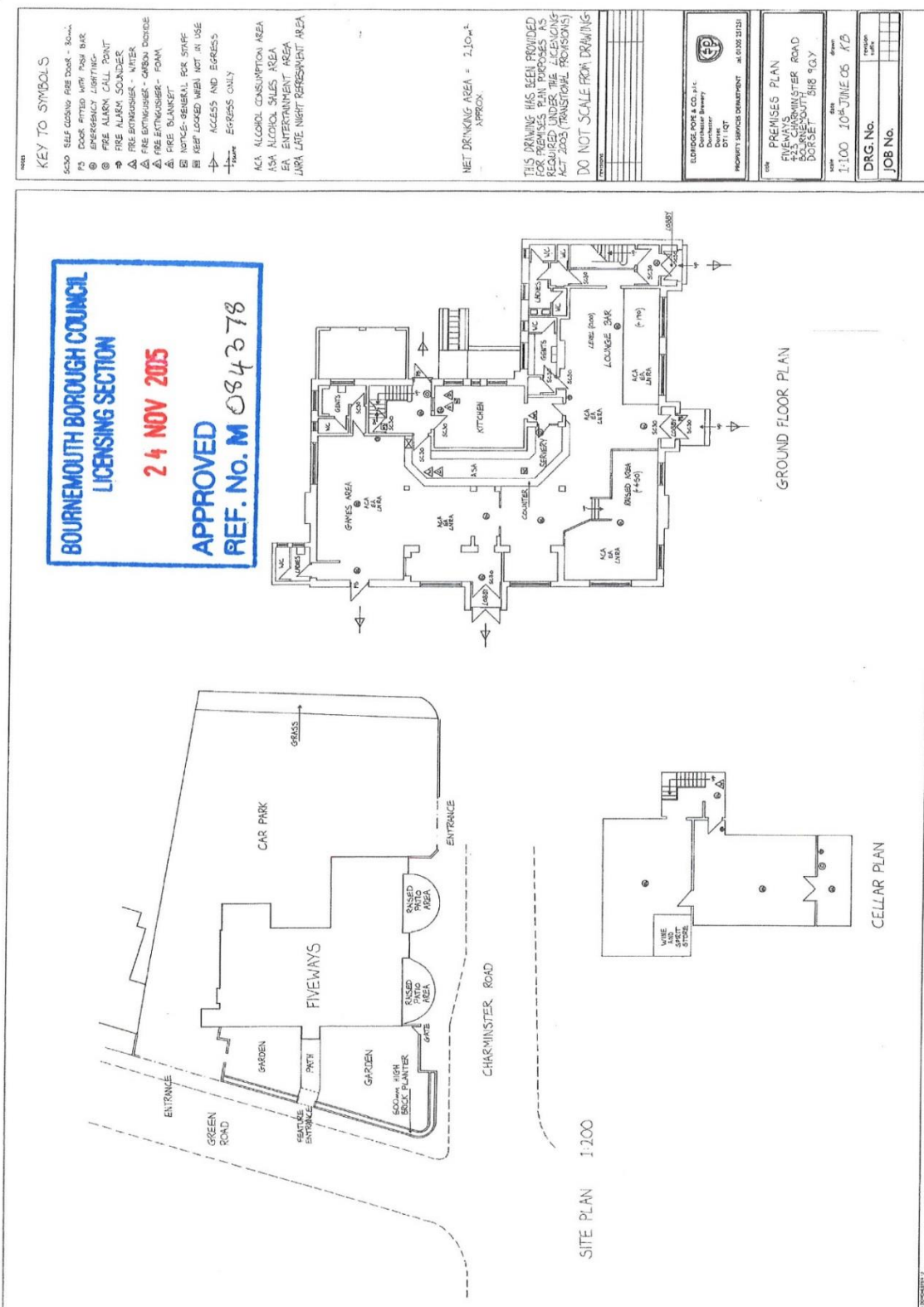

## Premises Licence Part B

Premises licence number: BH084378

<b>Postal address of premises, or if none, ordnance survey map reference or description:</b>	
Fiveways 423 Charminster Road	
<b>Post town:</b> Bournemouth	<b>Post Code:</b> BH8 9QY
<b>Telephone number:</b> 01202 549673	

<b>Licensable activities authorised by the licence:</b>
Live Music, Recorded Music, Performances of Dance, Activity like Music / Dance, Late Night Refreshment, Supply of Alcohol

<b>The times the licence authorises the carrying out of licensable activities:</b>
<b>Live Music:</b> (Indoors) Monday to Saturday - 10:00 to 00:00, Sunday - 11:00 to 23:00 <b>Recorded Music:</b> (Indoors) Monday to Saturday - 10:00 to 00:00, Sunday - 11:00 to 23:00 <b>Performances of Dance:</b> (Indoors) Monday to Saturday - 10:00 to 00:00, Sunday - 11:00 to 23:00 <b>Activity like Music / Dance:</b> (Indoors) Monday to Saturday - 10:00 to 00:00, Sunday - 11:00 to 23:00 <b>Late Night Refreshment:</b> (Indoors) Monday to Saturday - 23:00 to 00:00 <b>Supply of Alcohol:</b> Monday to Saturday - 11:00 to 00:00, Sunday - 11:00 to 23:00 <u>Non-standard timings for the supply of alcohol.</u> From 11:00 on New Year's Eve until 11:00 New Year's Day. On each Thursday, Friday, Saturday and Monday of a Bank Holiday weekend until 01:00 and on each Sunday of such weekend until 00:00.

<b>The opening hours of the premises:</b>
Monday to Saturday - 10:00 to 00:30, Sunday - 11:00 to 23:30 <u>Non-standard timings.</u> From 11:00 on New Year's Eve until 11:00 New Year's Day. On each Thursday, Friday, Saturday and Monday of a Bank Holiday weekend until 01:00 and on each Sunday of such weekend until 00:00.

<b>Where the licence authorises supplies of alcohol whether these are on and/ or off supplies:</b>
Alcohol will be consumed on and off the premises

<b>Name, (registered) address, telephone number and email (where relevant) of holder of premises licence:</b>
Marston's Plc, St Johns House St Johns Square, Wolverhampton WV2 4BH

<b>Registered number of holder, for example company number, charity number (where applicable):</b>
00031461

<b>Name of designated premises supervisor where the premises licence authorises the supply of alcohol:</b>
Mrs Hayley Connell

<b>State whether access to the premises by children is restricted or prohibited:</b>
N/A

Issued: 24 November 2005

Revised: 29 March 2023 [Change of Registered Address]

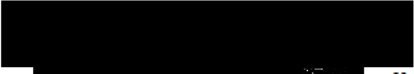
  
Mrs Nanhanka Randle

Licensing Manager

**Fiveways Charminster Road Bournemouth**

**Full Variation Application**

**Representations Received**

Rep #	
1	<p data-bbox="300 524 986 560">Re- The Fiveways, 432 Charminster Road BH8 9QY</p> <p data-bbox="300 595 529 631">Dear Sir/ Madam,</p> <p data-bbox="300 667 986 703">I would like to object to the above licensing changes.</p> <p data-bbox="300 730 1382 936">I am a local resident. This pub is in a residential area. Local residents, are plagued by pub clients using our street and Fampoux Gardens as an extension to the pub, cause damage to property, noise issues and harm to local children, through noise disturbing their sleep and the frequent occurrence of men exposing themselves whilst urinating in the street and in people's front gardens.</p> <p data-bbox="300 972 1382 1178">These people leave with alcoholic beverages and drink in large groups and use people's garden walks as benches. In Fampoux Gardens, they feel they are hidden and I believe they are taking drugs as well as drinking drinks bought from the pub. There are often violent altercations late at night and parking is a nightmare. People often drink drive, so at pub closing time the street erupts with people loudly stand around cars with music playing before roaring off.</p> <p data-bbox="300 1214 1382 1438">The outside area is incredibly noisy, but thankfully shuts at 10pm. If this was allowed to stay open until midnight/ 1am and host live music, play music or show films then local residents would have their quality of life and sleep disturbed, beyond a reasonable time. Not everyone wants to be up until midnight / 1am every weekend, especially not the children who live in house near the pub. This is a residential area, not the middle of the town centre or busier parts of Charminster Road.</p> <p data-bbox="300 1473 1382 1644">The showing of films outside will also cause noise issues and disturb local residents. The pub is not in the town centre, it's in a residential area. As such the extended licensing hours and especially the extended outside hours would stop residents from enjoying their homes and being able to sleep without every Friday and Saturday night being disturbed.</p> <p data-bbox="300 1680 1382 1904">We are plagued by incidents at present and the inability to get through to the police means a-lot of incidents-have gone unreported. These extended hours with people outside beyond 10pm will make living in the local area unbearable and will effect house prices and local residents quality of life, as well as increase the amount of public nuisance and harm to local children via these noise disturbances and inappropriate behaviours, such as exposing themselves whilst urinating in people's gardens.</p> <p data-bbox="300 1939 1382 2038">My car has become a bumper car for the pubs drunk drivers and my evenings noisy, whilst the pubs garden is open, currently until 10pm and then a second eruption when the pub closes. I strongly object to these proposed changes.</p>

	<p>There have been many incidents that have arisen from the pub. A man was recently tasered by police after leaving the pub drunk/high and jumping on the roof of a car parked in my road. There was an incident with an axe in the last two weeks, again the police were involved. These are major criminal and anti social behaviours, on top we have drunken arguments daily, loud music from cars at all hours, we have loud drunken people in our streets at all hours. Sometimes it feels unsafe to leave the house. These people park over our drive ways and when approached are aggressive.</p> <p>I bought my house 23 years ago. Pubs opened at 11 and shut at 11. Outdoor live music was never allowed. This is a residential area. People need to be able to use their homes without extra noise that music, live entertainment and the showing of films outside until 23.00 or 1.30 am. People should not feel afraid to leave their homes due to drunken, abusive people. Local residents should not have to accept damage to property. If this late license is allowed then local residents will suffer from late night noise from the entertainment and drunk people using our street and Fampoux Gardens as an extension to the pub. The noise from the pub garden already stops us from bringing able to open our windows on a hot day. This does not seem reasonable.</p>
2	<p>To: Licensing Team, BCP Council  Email: <a href="mailto:licensing@bcpcouncil.gov.uk">licensing@bcpcouncil.gov.uk</a>  Subject: Objection to Licensing Variation Application – Reference 232254  Premises: Fiveways, 423 Charminster Road, Bournemouth BH8 9QY  Applicant: Marston's Plc  Application Date: 22 October 2025  Consultation Ends: 19 November 2025</p> <p>Dear Licensing Team,</p> <p>I am writing to formally object to the proposed variation of the premises licence for Fiveways, 423 Charminster Road, Bournemouth, submitted by Marston's Plc. The application seeks to extend licensable activities until 01:00 AM on weekends, introduce outdoor films and sporting events, and modify the Premises' layout. This objection is grounded in material licensing and planning considerations, supported by both local and national policy frameworks.</p> <p>It is important to emphasise that the proposed licence variation includes the screening of outdoor films and sporting events in the front seating area, situated at the corner of Charminster Road and Green Road. In conjunction with extended operating hours, the applicant intends to install auditorium-style seating, which would significantly increase the capacity of the outdoor space beyond what would typically and reasonably be expected for such an area.</p> <p>Following a direct conversation with the Landlord, it was confirmed that the plan involves constructing stadium-style seating up to three tiers, along with additional ground-level seating in the same outdoor area. This clearly indicates that the variation is designed to accommodate a substantially larger number of patrons. Furthermore, the proposed outdoor television screen will be fitted with two speakers to ensure sound coverage across the entire space. It is particularly relevant to note that residential properties are located less than 20 metres from the boundary of the premises.</p>

	<p>I now wish to set out substantive concerns that align with recognised grounds for opposing licensing application.</p> <p>1. Public Nuisance – Noise and Late-Night Disturbance</p> <p>1.1 The Premises are situated in a densely populated residential corridor. The introduction of amplified outdoor entertainment and increased footfall during late hours will result in:</p> <ul style="list-style-type: none"> <li>• Elevated noise levels from patrons and outdoor screenings</li> <li>• Sleep disruption for families and vulnerable residents</li> <li>• Adverse impacts on health and quality of life due to noise and disturbance</li> </ul> <p>1.2 This contravenes the principle of the:</p> <ul style="list-style-type: none"> <li>• Licensing Objective: Prevention of Public Nuisance</li> <li>• Noise Act 1996 (which recognizes late-night noise (between 11:00 PM and 7:00 AM) as a statutory nuisance)</li> <li>• Core Strategy Policy CS38 – Managing Noise and Pollution</li> <li>• Saved Policy 6.10 – Protection of Residential Amenity</li> </ul> <p>2. Safeguarding Children</p> <p>2.1. Within a two-mile radius of the Premises, there are more than twelve educational institutions, including nurseries, primary schools, and secondary schools, that serve the local community. This strongly indicates a significant presence of minors residing in or frequently passing through the immediate vicinity of the Premises.</p> <p>2.2. The proposed variation, which aims to draw patrons outside to watch sporting events or films (during the day and up to 01:00) in an alcohol led venue raises serious safeguarding concerns such as:</p> <ul style="list-style-type: none"> <li>• Increased risk of exposure of minors to alcohol-related behaviour</li> <li>• Increased risk of minors being directly or indirectly impacted or exposed to anti-social behaviour</li> <li>• Increased risk to minors' early social behaviour, well-being and learning development.</li> </ul> <p>2.3. This undermines the:</p> <ul style="list-style-type: none"> <li>• Licensing Objective: Protection of Children from Harm and</li> <li>• National Planning Policy Framework (NPPF) – Promoting Healthy and Safe Communities</li> </ul> <p>3. Highway Safety and Parking Impact</p> <p>3.1. The application anticipates increased visitor numbers, however, there is already inadequate parking to accommodate current footfall. This will lead to:</p> <ul style="list-style-type: none"> <li>• Overspill parking on residential streets (substantially worsening local residences current parking challenges due to the location of the Premises)</li> <li>• Increased congestion and pedestrian safety risks, especially for children walking to and from their respective schools.</li> </ul> <p>3.2. This contravenes:</p> <ul style="list-style-type: none"> <li>• NPPF Paragraph 108 – Safe and Suitable Access</li> <li>• Core Strategy Policy CS16 – Parking Standards</li> </ul> <p>4. Cumulative Impact and Crime Prevention</p> <p>4.1. The area is already subject to Cumulative Impact Zone (CIZ) policies due to the proliferation of licensed premises.</p> <p>4.2. The proposal raises community safety concerns and undermines:</p> <ul style="list-style-type: none"> <li>• Licensing Objective: Prevention of Crime and Disorder</li> <li>• Town Centre Area Action Plan (2013)</li> <li>• Local Plan Policy DEF</li> </ul>
--	-----------------------------------------------------------------------------------------------------------------------------------------------------------------------------------------------------------------------------------------------------------------------------------------------------------------------------------------------------------------------------------------------------------------------------------------------------------------------------------------------------------------------------------------------------------------------------------------------------------------------------------------------------------------------------------------------------------------------------------------------------------------------------------------------------------------------------------------------------------------------------------------------------------------------------------------------------------------------------------------------------------------------------------------------------------------------------------------------------------------------------------------------------------------------------------------------------------------------------------------------------------------------------------------------------------------------------------------------------------------------------------------------------------------------------------------------------------------------------------------------------------------------------------------------------------------------------------------------------------------------------------------------------------------------------------------------------------------------------------------------------------------------------------------------------------------------------------------------------------------------------------------------------------------------------------------------------------------------------------------------------------------------------------------------------------------------------------------------------------------------------------------------------------------------------------------------------------------------------------------------------------------------------------------------------------------------------------------------------------------------------------------------------------------------------------------------------------------------------------------------------------------------------------------------------------------------------------------------------------------------------------------------------------------------------------------------------------------------------------------------------------------------------------------------------------------------------------------------------------------------------------------------------------------------------------------------------------------------------------------------------------------------------------------------------------------------------------------------------------------------------------------------------------------------------------------------------------------------------------------------------------------------------------------------------------------------------------------------------------------------------------------------------------------------------------------------------------------------------

	<p>Conclusion</p> <p>I respectfully urge the Licensing Committee to refuse this application in its current form.</p>
3	<p>I am writing to formally object to the proposed variation of the premises licence for the Fiveways Pub. I understand the application seeks to extend the licensed hours and introduce live music and televised sport outdoors. I have serious concerns that granting this variation would have a negative impact on the local community.</p> <p>1. Prevention of Crime and Disorder</p> <p>Extending the licensing hours and encouraging outdoor gatherings late into the evening will likely attract increased antisocial behaviour and criminal activity. The area already experiences issues with disorderly conduct linked to the premises, and I am aware that drug use and related activities have taken place there. Allowing later hours and additional outdoor entertainment will only exacerbate these problems. Also, there are lots of times when people venture over to the Famboux Gardens and unsolicited events take place.</p> <p>2. Public Safety</p> <p>An increase in the number of patrons outside the premises, particularly during live music events or televised sports, raises significant safety concerns. There is a greater risk of fights, noise-related confrontations, and incidents of intoxication that could threaten both customers and nearby residents. Often people wonder up and down the road, smashing glasses and littering.</p> <p>3. Prevention of Public Nuisance</p> <p>Outdoor music and televised sport will generate substantial noise, particularly during the evening and night-time hours. This will disturb local residents, disrupt families, and reduce the overall quality of life in the neighbourhood. Many of us live close to the premises and already experience noise from patrons leaving the venue; extended hours will make this much worse.</p> <p>4. Protection of Children and the Community from Harm</p> <p>This area is home to many families, and we must prioritise their safety and wellbeing. The reported use of drugs at the premises is particularly concerning, and it is our duty as residents and the council's duty as a licensing authority to protect the community from harm.</p> <p>In summary, I believe the proposed changes will increase crime and disorder, compromise public safety, create public nuisance, and put our community at greater risk. I respectfully request that the council reject this licence variation application in order to preserve the safety and wellbeing of local residents.</p>
4	<p>I have been informed about the changes that the Fiveways pub would like to make to their licence.</p> <p>I am not at all for this change as they already have a noise reduction curfew in place that's sub average. We have lived on Green Road for a year and a half now and we have already witnessed events that have happened from fights, shouting, drunken disorderly people urinating up the side of our property as well as our neighbours property's too. Vomiting up our wall and leaving drinks in our flower bed.</p>

	<p>We struggle to park outside our property at the best of times due to trades men parking their work vans down our road rather than using the car park as they will be at the pub for 3-4 hours which then indicates drunk driving.</p> <p>This is a road full of families with young children and we work 6 days a week where we are up early and if the pubs outside area is open till 1am this is going to be very disruptive and concerning for us and our neighbours.</p> <p>This will cause more havoc down our road with issues of not getting parked, drunk drivers hitting residents cars and anti social behaviour. I would not feel safe leaving my property late in the evening with the pub attendees roaming around in numbers.</p> <p>Having lived in Southbourne and seeing how the local bars and pubs operate they all abide by the 10pm curfew as so the neighbours are not disturbed and it works just fine, the fiveways are no different and should be abiding to the 10pm curfew just like all other pubs and bars do.</p> <p>Therefore my partner and I at ..... Green Road are opposed to the proposed license changes to the fiveways pub and hotel.</p>
5	<p>I am writing to formally object to the proposed changes to the premises licence for The Fiveways Pub . My objection is based on the following concerns, which relate directly to the Licensing Objectives of the prevention of public nuisance, prevention of crime and disorder, and the protection of children from harm.</p> <p>I am a local resident and live in the opposite buildings, and the proposed changes would have a significant negative impact on our quality of life and the safety of the neighbourhood.</p> <p><b>1. Prevention of Public Nuisance</b> The pub is already a source of considerable noise in the evenings. Extending licensing hours or increasing capacity is likely to exacerbate this issue, especially with patrons leaving the premises late at night. The noise disturbance currently affects local residents, including children, and longer hours will further impact our right to a peaceful night's sleep.</p> <p><b>2. Prevention of Crime and Disorder</b> An increase in the availability of alcohol and later operating hours could lead to increased anti-social behaviour and potential crime. Concerns around the potential for drunken behaviour in the immediate vicinity of a residential area are valid and must be considered. This could make the local area feel less safe for residents.</p> <p><b>3. Protection of Children from Harm</b> Many children reside in the buildings opposite the pub. Increased late-night noise and potential exposure to anti-social or drunken behaviour pose a risk</p>

	<p>to their well-being and safety. The licensing authority has a duty to ensure the protection of children from harm.</p> <p>For these reasons, I urge the Licensing Sub-Committee to refuse the application for the licence changes.</p> <p>I do not wish that my name and address be shared with the applicant.</p> <p>Thank you for your time and consideration of my concerns.</p> <p>Yours sincerely,</p>
6	<p>To whom it may concern,</p> <p>I write to object to the application to vary premises licence (ref-232253) for The Fiveways at 423 Charminster Road, Bournemouth, BH8 9 QY, made by Marston's Plc.</p> <p>I am concerned with regards to the proposal to:</p> <ol style="list-style-type: none"> <li>1. 'Extend hours for supply of alcohol , regulated entertainment and late night refreshment until 01:00 on Friday and Saturday and until 00:00 on Sunday'.</li> <li>2. 'Add films (indoors and outdoors) and indoor sporting events from 11:00 to 00:00 on Sunday to Thursday and 11:00 to 01:00 on Friday and Saturday'.</li> </ol> <p>Preventing public nuisance: The pub is in a busy residential neighbourhood where lots of families live. If they start showing loud movies or sports outside and stay open later, it could cause problems like:</p> <ul style="list-style-type: none"> <li>• more noise from people and tv/music speakers</li> <li>• kids and families who live in the area being kept awake at night</li> <li>• people who live in the area feeling stressed or disturbed by the noise</li> </ul> <p>Extending the opening hours for the supply of alcohol is also likely to result in increased noise levels until the late hours, including at closing time when patrons leave. This is already an issue in the area with the pub's current opening hours. With a late licence, it is also likely that the pub will attract intoxicated patrons from other pubs / restaurants that do not have a late licence, also increasing noise levels late at night.</p> <p>Protecting children from harm: There are several schools and nurseries in the vicinity, so lots of children and teenagers live or pass through the area regularly. I am concerned about the plan to show outdoor films and sports, especially when alcohol is involved, as it could mean children are exposed to drunken or rowdy behaviour, and there's an increased chance of anti-social behaviour affecting them.</p>



	<p>This kind of activity goes against the rules that are meant to protect children and doesn't help to build a safe and healthy community.</p> <p>Public safety: The proposed location of the external bar, outdoor screen, and flexible tiered seating is adjacent to a busy bus stop, that children and families use frequently which also increases the risk to public safety.</p> <p>It is also very close to both Charminster Rd, including the busy roundabout, and Green Rd and vehicles driving past will be distracted by the outdoor screen, increasing the risk of accidents.</p> <p>Preventing crime and disorder: Increased footfall and extended 'late license' opening hours will no doubt increase the anti-social behaviour in the area as well as crime. We are already exposed to arguments and fights on Green Road from intoxicated patrons of The Fiveways. There is also already a litter problem on Green Road due to pub patrons drinking cans and bottles of alcohol outside the pub and in their cars before, during and after visiting the pub, and leaving the empty cans and bottles on the road. The use of drugs in vehicles of people visiting the pub is also frequent.</p> <p>I request that these aspects are taken into consideration, and to refuse the application made by Marston's Plc.</p>
7	<p>I am writing as a local resident and Mum of two young boys to formally object to the application made by Marston's plc to vary the premises licence at the Fiveways pub in Charminster Road.</p> <p>My objection is based on the grounds that granting this licence will undermine the following licensing and objectives:</p> <ul style="list-style-type: none"> <li>• Prevention of Public Nuisance</li> <li>• Public Safety</li> <li>• Prevention of Crime and Disorder</li> <li>• Protection of Children from Harm</li> <li>•</li> </ul> <p>My concerns and the reasons for my objection are detailed below:</p> <p><b>Prevention of Public Nuisance</b></p> <p>The pub is located in a densely populated residential area, an area which the council has been working hard to make a hub for families by reducing the number of student housing. An extension of the licensing hours, particularly into the early hours of the morning, will inevitably lead to a significant increase in noise and disturbance for local residents, many of which are young families.</p> <p>Specific issues that will cause a public nuisance include:</p> <ul style="list-style-type: none"> <li>• Noise from patrons leaving the premises: Groups of people gathering outside, shouting, laughing, and talking loudly in the street as they</li> </ul>

	<p>leave the pub late at night or early in the morning will disrupt the sleep of residents, including families like myself with young children.</p> <ul style="list-style-type: none"> <li>• Noise from amplified music/events: the proposed late hours of both the pub and its outside area will mean an increase in noise for local residents. The Fiveways website already is making claims about its “goose-bump-giving subwoofer stadium sound” which already causes deep concern during summer months when windows will be open and my young children are trying to get a good nights rest. We have raised our concerns with the council about the sound disturbance of events from the pub in recent years so using the outdoor space will only amplify the volume for residents.</li> <li>• Increased vehicle traffic and taxi movements: The extended hours will generate more traffic, including taxis and private cars, with associated noise from engines, car doors slamming, and people waiting to be picked up in a quiet residential street. Furthermore, the pub has insufficient parking onsite so it's very usual, even at quiet times for there to be an over spillage of cars and vans on to our road. At peak times, such as a Friday afternoon I find myself bringing home two tired young boys and not being able to park anywhere near my house and on occasion has been near impossible to get us all out of the car and safely indoors without the help from neighbours. It's even come to a point that I now change plans to ensure we come straight home after school to ensure we secure a close parking.</li> <li>• Antisocial behaviour: Late night activity often results in littering (e.g., broken glass, cigarette butts, half finished drinks being left along the road and in gardens), public urination, and other antisocial behaviour such as fights in the immediate vicinity. We are left to clear up the mess left behind plus I have reported both a fight and drug abuse to the Police in relation to patrons of the pub over recent years.</li> <li>• Cumulative impact: There are already several licensed premises in the area, and extending the hours for this pub would exacerbate the existing late-night issues, creating a "second wave" of disturbance for the police to deal with after other venues have closed and may encourage already inebriated patrons to the Fiveways to make their night that little bit longer.</li> </ul> <p><b>Public Safety</b></p> <p>Firstly, as a Mum it's very rare I choose to walk my sons directly past the current outdoor area especially at busy times. And secondly, as a female who enjoys running I always ensure I am not directly going past the outside pub area and always opt to cross over the road. This is even the case when I'm just popping to the local shop. My concerns are due to the patrons mainly being male and creating a heavily sports focussed environment as insinuated on the Fiveways website about its new brand will not change this or make many females any more welcome. Further more, the thought of</p>
--	---------------------------------------------------------------------------------------------------------------------------------------------------------------------------------------------------------------------------------------------------------------------------------------------------------------------------------------------------------------------------------------------------------------------------------------------------------------------------------------------------------------------------------------------------------------------------------------------------------------------------------------------------------------------------------------------------------------------------------------------------------------------------------------------------------------------------------------------------------------------------------------------------------------------------------------------------------------------------------------------------------------------------------------------------------------------------------------------------------------------------------------------------------------------------------------------------------------------------------------------------------------------------------------------------------------------------------------------------------------------------------------------------------------------------------------------------------------------------------------------------------------------------------------------------------------------------------------------------------------------------------------------------------------------------------------------------------------------------------------------------------------------------------------------------------------------------------------------------------------------------------------------------------------------------------------------------------------------------------------------------------------------------------------------------------------------------------------------------------------------------------------------------------------------------------------------------------------------------------------------------------------------------------------------------------------------------------------------------------------------------------------------------------------------------------------------------------------------------------------------------------------------------------------------------------------------------------------------------------------------------------------------------------------------------------------------------------------------------------------------------------------------------------------------------------------------------------------------------------------------------------------------------------------------------------------------------------------------------------------------------------------------------------------------------------------------------------------------------------------------------------------------

	<p>these changes to increase the pubs outside offering and capacity makes me very anxious about walking past.</p> <p>Having such an area complete with a screen on such a busy road could also be a distraction for drivers and therefore increase traffic accidents. There is a bus stop directly outside the pub garden, it's used by many families, senior citizens and is a 24 hour service. The safety of those using the bus stop and having to wait for some time for their bus is also of concern to me, especially for example if it's in the early hours of the morning.</p> <p><b>Prevention of Crime and Disorder</b></p> <p>A late-night licence, particularly for a pub, can increase the risk of crime and disorder in the area. The presence of intoxicated people in the early hours of the morning increases the potential for arguments, aggressive behaviour, and potentially violent altercations. As mentioned above, I have reported at least two separate occasions to the police of crime and disorder directly related to patrons of the pub.</p> <p><b>Protection of Children from Harm</b></p> <p>As a Mum to two young boys I am very aware that there are many families like us living in the local area. Uninterrupted sleep is critical for a child's well-being and development. The noise and potential antisocial behaviour associated with a late-night extension would directly harm their living environment and disrupt their sleep patterns.</p> <p>In summary I strongly believe that a late-night extension is not compatible with the quiet residential character of this area. The detrimental impact on residents' quality of life, peace, and sleep far outweighs any potential commercial benefit to the pub.</p> <p>I urge you to consider that our homes are our sanctuary, our safe place and we feel we are already tolerating various disturbances to our everyday lives attributable to the pub. Please consider the welfare of the existing community and what further stresses and strains these changes may have to us and our children, I would ask on this basis that you reject this application.</p> <p>Yours sincerely</p>
8	<p>Dear Sirs,</p> <p>I would like to object against the Fiveways pub application to change their licence to extend hours for supply of alcohol and entertainment.</p> <p>The pub is already causing noise nuisance. The pub attracts crowds of young people who drink too much and behave disorderly. I live on Rutland Road and have witnessed groups of young people leaving the pub, shouting</p>

	<p>and behaving aggressively. I also used to live at flat 15 queens court, charminster road, right opposite the main entrance to the pub and made a complaint to the pub manager about playing live music past 11pm.</p> <p>There were many incidents when police was being called and there are articles in bournemouth daily echo to confirm this. There are also many unreported incidents of antisocial and aggressive behaviour which are witnessed by the residents of surrounding area on a regular basis. The extension of the pub working hours and alcohol supply will only make the existing problems worse.</p> <p>With kind regards</p>
<b>9</b>	<b>WITHDRAWN</b>
<b>10</b>	<p>Dear Sir/Madam,</p> <p>I am writing as a local resident of Queens Court, Charminster Road, Bournemouth, BH8 9SF to formally object to the proposed extension of opening hours and alcohol sales at Fiveways Pub located at 423 Charminster Road, Bournemouth, Dorset, Bh8 9QY.</p> <p>While I understand the value of local businesses and community venues, this particular establishment has already been a source of significant disturbance late at night. On many occasions, there have been loud noises, shouting, and even fights occurring outside the premises after closing time. These incidents often take place between 6pm-midnight, disturbing residents' peace and sleep.</p> <p>Extending the hours of operation and alcohol sales until midnight would likely increase these problems, making it even more difficult for local residents to enjoy a safe and quiet environment. The current noise levels already exceed what could reasonably be considered acceptable in a residential area, and further extension would only worsen the impact on the community.</p> <p>I therefore respectfully request that the Licensing Committee <b>decline the application</b> for extended hours.</p> <p>Thank you for taking my concerns into consideration. I would appreciate confirmation that my objection has been received and recorded for the upcoming hearing or review.</p>
<b>11</b>	<p>Petition with 23 signatures</p> <p>Dear Sir/Madam</p> <p>I am writing to submit a copy of the objection document regarding the application for extended opening hours and an alcohol licence at Five ways pub at 423 Charminster Road, Bournemouth.</p> <p>Please find attached the copy of the objection letter, which includes the</p>

	<p>collected signatures from local residents. The original signed document has been sent to you by post for your records.</p> <p>Kindly confirm receipt of this email and the attached document. Thank you for your attention to this matter.</p> <p>We, the local residents surrounding the Fiveways pub, write as one to formally object to the change of licence that has been proposed.</p> <p>While we understand the value of local businesses and community venues, this particular establishment has already been a source of significant disturbance late at night. The pub has already broken the existing licensing rules by allowing the music to be played beyond 11pm on many occasions. There have been loud noises, shouting, vandalism, and violent fights occurring outside the premises. These incidents often take place in the evening and after closing, fuelled by alcohol, disturbing residents' peace and sleep.</p> <p>There have been a string of violent incidents, some of which include (but are not limited to):</p> <p><a href="https://www.bournemouthcho.co.uk/news/18562439.fights-bournemouth-pubs-open-first-time-months/">https://www.bournemouthcho.co.uk/news/18562439.fights-bournemouth-pubs-open-first-time-months/</a></p> <p><a href="https://www.bournemouthcho.co.uk/news/20128275.man-injured-fight-outside-pub-bournemouth/">https://www.bournemouthcho.co.uk/news/20128275.man-injured-fight-outside-pub-bournemouth/</a></p> <p><a href="https://www.bournemouthcho.co.uk/news/19268710.two-arrested-breaking-mans-jaw-fight-bournemouth/">https://www.bournemouthcho.co.uk/news/19268710.two-arrested-breaking-mans-jaw-fight-bournemouth/</a></p> <p><a href="https://www.bournemouthcho.co.uk/news/23615412.dock-people-appeared-pooles-magistrates-court/">https://www.bournemouthcho.co.uk/news/23615412.dock-people-appeared-pooles-magistrates-court/</a></p> <p>Further incidents will no doubt be evidenced by Dorset police. There are also a significant number of unreported incidents, which the local residents will happily corroborate. With policing and healthcare services already stretched to the limit, this would be an unmitigated disaster for crime and antisocial behaviour in this area.</p> <p>Extending the hours of operation and alcohol sales would only exacerbate these existing problems, making it impossible for local residents to enjoy a safe and quiet environment. Lack of sound insulation and doors being propped open for ventilation are already an existing and unaddressed problem of the noise nuisance.</p> <p>The quote hanging below the Fiveway's sign is "A great local, for great locals". Unfortunately majority of the pub visitors are not local, which can be witnessed by the amount of parked vehicles outside the pub, and the true local people are suffering. We (the great locals) therefore respectfully request that the Licensing Committee decline the application for extended hours.</p> <p style="text-align: right;"><i>Scanned by TapScanner</i></p>
12	<p>Dear Sir/Madam,</p> <p>As a local resident I wish to register my strong objection to the application (Ref: 232254) of Marston's PLC - Fiveways Pub, located at 423 Charminster Road Bournemouth BH8 9QY, that aims to make multiple changes to its current operations.</p> <p>Proposed change: extended hours to 01:00 Friday, or 00:00 weekends.</p> <p><b>Objection:</b></p> <p>This is a residential area with many families with young children; it is entirely inappropriate to encourage extended and excessive drinking in such an area. It is not a suitable area to encourage late night drinking, it would be</p>

	<p>more suitable in Bournemouth town centre, which is not where this pub is located.</p> <p>There is already enough antisocial behaviour in area and extended hours will only serve to exacerbate this and create more issues. It will put additional strain on the police to manage the inevitable drink related violence/antisocial behaviour that will be caused by extended drinking hours.</p> <p>It will also stand to further encourage traffic and parking in residential roads usage in the area as it draws in more people to the location.</p> <p>From a health point of view, we should not be encouraging people to continue to drink for longer. It does not align with the BCP's life style objectives nor is it appropriate to expose young children living in the area to such excesses.</p> <p>Proposed change: add films indoors and outdoors.</p> <p><b>Objection:</b></p> <p>More or less the same reasons as above. Once again this is a residential area, with the additional noise and disruption from the proposed films and sports events being shown outside is unacceptably unfair on local residents, even more for families with children trying to sleep. In sports events it will only further encourage noise and antisocial behaviour for already long-suffering local residents.</p> <p>As a proposed objective is to: "further promote the protection of children from harm licensing objective". Surely it would be best to fulfil this objective by rejecting these proposals and ensuring the protection of children.</p> <p>I strongly urge the reviewing board to see sense and reject these proposals.</p>
13	<p>Dear Sir/Madam,</p> <p>I would like to formally object to the licence variation requested by The Five Ways Pub (licence number BH084378) on the grounds of:</p> <ul style="list-style-type: none"> <li>• preventing crime and disorder</li> <li>• public safety</li> <li>• preventing public nuisance</li> <li>• protecting children from harm</li> </ul> <p>Residents and the public will be adversely affected by this change if it goes ahead and will be a negative impact on the area.</p> <p>Such entertainment should be confined to non-residential or more urban areas where nightlife is more prevalent such as the town centre.</p> <p>Kind regards,</p>

14	<p>Good afternoon,</p> <p>My name is ....., I am contacting you today to forward my/our strong objections against the Fiveways Pub changing their licence, opening hours, outside bar area and outside screening.</p> <p>As a family myself, Husband and 2 children, we live ..... Fiveways Pub, My husband has lived here in this house for 50 years. We have seen lots of changes in the property and landlords over the years, some good and others tolerable. This change however is the most ridiculous.</p> <p>Daily we suffer with lack of parking – where are all these customers meant to park? We have a garage and drop curb, yet we struggle to park outside our house due to customers choosing to park in Green Road rather than the already cramped carpark provided.</p> <p>Cars are parked without care, left overnight, our cars are damaged, reversed or driven into, that is if we can park at all! Just this weekend my husband in the dark drove over a pint glass that had been left by our driveway, causing it to shatter in the road and under our tyre.</p> <p>Glasses being taken and left outside of the pub is a daily occurrence, finding them in our garden, balanced on the wall or white bollards to the side of the car park area, and I know that they are also taken further up the road and wider area. It's us residents that must clean up the broken glass, sick and wash urine way from the pavements and our properties.</p> <p>Customers, usually male, but the occasional female, come out from the pub gardens and urinate where they want, rather than using the pub toilets.</p> <p>They go against our garden wall, garage door, over the road in the bushes is a favourite, the entrance to Fampoux Gardens, a plot of land given to the soldiers it is named. This is also where they choose to take their pint with a mate or two, to smoke or take drugs, then return to the pub.</p> <p>We have complained to police, reporting drug taking and dealing activity over the years, that is coming from the pub, which is also well known inside to staff and not just customers partaking.</p> <p>The police are called on a regular basis to fights that have broken out, drunk drivers, damage caused to property and cars and general rowdiness, shouting and swearing for example. The amount of over intoxicated customers that leave or are kicked out at the end of a night is staggering. Leaving them to cause chaos outside in our road, our house area, past 11pm. We lay in bed listening and thinking about what we are hearing and will it affect us most weekends.</p> <p>Things get worse when there is a large football game for example on the TV. Customers will be drinking for longer periods of time, cars parked wherever they choose, shouting and loud cheering, arguing and</p>
----	---------------------------------------------------------------------------------------------------------------------------------------------------------------------------------------------------------------------------------------------------------------------------------------------------------------------------------------------------------------------------------------------------------------------------------------------------------------------------------------------------------------------------------------------------------------------------------------------------------------------------------------------------------------------------------------------------------------------------------------------------------------------------------------------------------------------------------------------------------------------------------------------------------------------------------------------------------------------------------------------------------------------------------------------------------------------------------------------------------------------------------------------------------------------------------------------------------------------------------------------------------------------------------------------------------------------------------------------------------------------------------------------------------------------------------------------------------------------------------------------------------------------------------------------------------------------------------------------------------------------------------------------------------------------------------------------------------------------------------------------------------------------------------------------------------------------------------------------------------------------------------------------------------------------------------------------------------------------------------------------------------------------------------------------------------------------------------------------------------------------------------------------------------------------------------------------------------------------------------------------------------------------------------------------------------------------------------------------------------------------------------------------------------------------------------------------------------------------------------------------------------------------------------------------------------------------------------------------------------------------------------------------------------------------------------------------------------------------------------------------------------------------------------------------------------------------------------------------------------------

<p>             fights when things do not go the way they want. Again, we notice more of this same behaviour when certain bands, live music or entertainment is on. The music can be so loud that we can hear it inside our house clearly, with windows closed. The bass and drumming going on for several hours.           </p> <p>             All these things also affect our children. Our son is Autistic and has learning difficulties, he is registered with a Blue Parking Badge and is unable to attend school due to his difficulties. Routine and stability are vital for him. Loud noises in general are triggering, causing unavoidable emotional and mental meltdowns.           </p> <p>             Hearing and seeing fights, police attendance and loud music are really distressing as we are unable to control these situations ourselves to help him understand and are unable to remove him from these as they are in our immediate living area! He has witnessed a customer being tasered outside our house, which you can only imagine the behaviour that person was presenting with. He hears the loud music when sleeping, leading to disrupted sleep and high anxiety. The glass bottle bin is emptied at the end of each night, despite being asked to leave it until the morning, due to its extremely loud smashing sound. No child should be woken up scared and be worried in their safe space.           </p> <p>             We as a family think that these new intended changes are and will be detrimental to our son's mental health and wellbeing, along with our own raised anxiety. Opening ours should not be allowed to be extended past 11pm.           </p> <p>             The noise from the massive screen inside and live/music should be limited, not to interfere with residents and end before final closing. The outside garden area is closed off at 10pm to try and reduce noise, this should still stand.           </p> <p>             Allowing films, music and games/matches to be played loudly outside is unbelievable with NO consideration to residents at all. Allowing opening times to be until 1:30am is inhumane and damning to us as a family and to the wider residents. Causing noise to rise, drinking hours being made longer and leading to far many intoxicated customers, which will then be left outside in our community area at around 2am, with cars leaving, shouting and a concern for anti-social behaviour. Where the outside screen is potentially wanting to be positioned, we will clearly be able to see and view films from our bedroom window with ease. We do not want to have a screen flashing and playing towards our house until 12/1-2am. My husband starts work between 5:30-6am each morning and attends emergency street appliance damage when needed in the early out of hours, many of these attended by police. This is an awful idea in general and has not been thought about for anything more than raising profit and footfall. As for a 'Community and family' pub, pa!           </p> <p>             This is going to be a sports bar, encouraging people, mostly male, to attend football matches and late night sports games in their masses, intending           </p>
-----------------------------------------------------------------------------------------------------------------------------------------------------------------------------------------------------------------------------------------------------------------------------------------------------------------------------------------------------------------------------------------------------------------------------------------------------------------------------------------------------------------------------------------------------------------------------------------------------------------------------------------------------------------------------------------------------------------------------------------------------------------------------------------------------------------------------------------------------------------------------------------------------------------------------------------------------------------------------------------------------------------------------------------------------------------------------------------------------------------------------------------------------------------------------------------------------------------------------------------------------------------------------------------------------------------------------------------------------------------------------------------------------------------------------------------------------------------------------------------------------------------------------------------------------------------------------------------------------------------------------------------------------------------------------------------------------------------------------------------------------------------------------------------------------------------------------------------------------------------------------------------------------------------------------------------------------------------------------------------------------------------------------------------------------------------------------------------------------------------------------------------------------------------------------------------------------------------------------------------------------------------------------------------------------------------------------------------------------------------------------------------------------------------------------------------------------------------------------------------------------------------------------------------------------------------------------------------------------------------------------------------------------------------------------------------------------------------------------------------------------------------------------------------------------------------------------------------------------------------------------------------------------------------------------------------------------------------------------------------------------------------------------------------------------------------------------------------------------------------------------------------------------------------------------------------------------------------------------------------------------------------------------------------



	<p>them to consume far more alcohol – evident in the lack of table seating being provided, instead bench/bar stools and high rise lean shelving instead. The food menu being advertised as family friendly is pointed straight at those who want a grab a bite and watch, like what you would find at a football pitch or sports stadium (hotdogs, chips, burgers etc). Unfortunately, this is a densely populated residential area, with the Fiveways in the middle, NOT a sports arena!</p> <p>We object to the changes proposed, believing that they will encourage and increase:</p> <p>Anti-social behaviour inside and outside the pub grounds, and wider community residential area.</p> <ul style="list-style-type: none"> <li>• Raised noise levels due to outside screening and music being played, with customers voices, singing and shouting.</li> <li>• Parking becoming dangerous and increasingly difficult for residents, parking is already inadequate.</li> <li>• Raise in intoxicated customers due to longer drinking times being made available, leading to fights, damage, drug activity, and other anti-social behaviour, damage to our personal family life and way of living, alongside other residents.</li> <li>• And many more issues that arise and we face only from living here.</li> </ul> <p>We know and understand we live next-door to a pub and have tolerated these situations and behaviours that come along with doing so, but this is ridiculous and totally unfair to all residents and community members.</p> <p>Please, DO NOT allow these changes to take place at the Fiveways pub. I look forward to receiving your feedback, Many kind regards,</p>
15	<p>Good morning</p> <p>I am emailing to express my concerns with regards to the extended hours of the Five ways pub.</p> <p>As a local resident on the junction on Charminster road and Charminster Avenue we already experience noise disturbances over weekends either due to the volume of the live music or the people leaving the pub.</p> <p>Some of these disturbances are not in good spirit and can either end up in fights or with the police being called.</p> <p>Extending the hours, live music and drinking time has the potential for the to continue or become worse.</p> <p>Please can my comments be included as an objection of this element of the request made.</p>

16	<p>Dear Sir/Madam,</p> <p><b>Re: Objection to Application for Extended Premises License – Fiveways Pub / Marstons Plc</b> 423 Charminster Road Bournemouth</p> <p>Reference: 23225</p> <p>I am writing to formally object to the application submitted by Fiveways pub / Marstons PLC for an extension to its premises license. As a resident living in close proximity to the pub, I have serious concerns about the potential impact this extension will have on the local community and the surrounding area.</p> <p>Specifically, my objections are based on the following:</p> <ol style="list-style-type: none"> <li>1. <b>Noise Disturbance:</b> Extending the pub's operating hours will likely lead to an increase in noise levels during late-night hours, which is already a concern in the area. The noise generated by patrons arriving, leaving, and congregating outside the pub can disturb the peace and quiet of the neighbourhood, especially during the evening and early hours. This could be disruptive to local residents, including families with young children and elderly individuals.</li> <li>2. <b>Public Safety:</b> There is a concern that later opening hours may exacerbate public safety issues. Extended hours could increase the risk of alcohol-related incidents, antisocial behaviour, and disturbances in the area. The potential for larger crowds and longer hours of operation could put additional pressure on local policing and emergency services.</li> <li>3. <b>Impact on Local Quality of Life:</b> As a resident, I am concerned that the extended operating hours could significantly affect my quality of life. Many of the surrounding properties are residential, and the pub's extended hours could detract from the peaceful environment that makes this area desirable for families and individuals alike. I believe the local community deserves to maintain a tranquil setting, which would be compromised by these changes.</li> </ol> <p>I kindly urge you to consider these concerns when reviewing the application. I believe that the potential negative impact on the local community outweighs any benefit that the extended hours may provide to the pub. I trust the council will take into account the views of local residents to ensure that the interests of the community are properly protected.</p> <p>Thank you for considering my objection. I would be happy to discuss my concerns further or provide any additional information if required. I look forward to your response.</p>
17	<p>I understand The Fiveways Pub have applied for changes to their licence. They have applied to have the outside area to be open until 23:00 Monday- Thursday and 01:00am Friday and Saturday.</p> <p>I wish to raise the following objections:</p>

	<p>1. Preventing crime and disorder. Already we are seeing antisocial Behaviour which spills over onto the surrounding roads and Fampoux gardens. This includes fighting and aggressive behaviour. Extending licensing will increase alcohol consumption and fuel further disorder. I have witnessed people leaving the pub and urinating in the street.</p> <p>2. Public safety. Increased alcohol consumption will increase the risk to local residents and their properties from alcohol fuelled antisocial behaviour.</p> <p>3. Preventing public nuisance. Noise from the Fiveways is already an issue for local residents. We are already disturbed by noise from outside ☐☐ long during current opening hours. Extending opening times will further impact on local residents.</p> <p>I frequently encounter broken glasses and vomit on the street and fear this will increase.</p> <p>I wish to strongly object to the requested licence changes as I fear it will have a significant detrimental effect on local residents</p>
18	<p>Good morning Sarah,</p> <p>I just want to raise I've had a number of representations from local residents about the license variation application for the Fiveways pub. A number of these have been over the phone and I've directed them to make written representations to licensing directly. However I just wish to raise this with you directly in case they do not write directly or before 19<sup>th</sup> November.</p> <p>I'd also like to make my own representation against the variation to add films (indoors and outdoors) and indoor sporting events from 10:00 to 00:00 on Sunday to Thursday and 10:00 to 01:00 on Friday and Saturday, and also to extend the licensable hours to 0000 on Sundays.</p> <p>I believe these to be inappropriate for a venue located in a residential area principally due to the noise that will be created disturbing local residents.</p> <p>Kind Regards,</p> <p><b>Cllr Chris Rigby</b> Winton East Ward Green Group Leader Chair of Environment &amp; Place O&amp;S Committee</p>
19	<p>The Prevention of Crime and Disorder:</p> <p>This variation is likely to cause crime and disorder in the area adjacent to this business.</p> <p>The Prevention of Public Nuisance:</p>

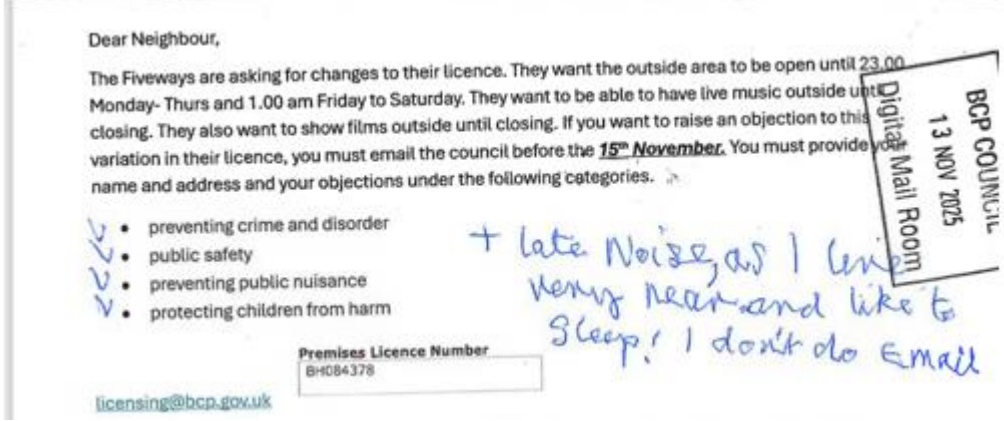
	<p>This variation will cause nuisance to residents in the area adjacent to this business to an unacceptable level through the increase in noise, amplified music etc.</p> <p>The Protection of Children from Harm:</p> <p>This variation is likely to cause harm to children living in the vicinity due to disturbance and noise in the area adjacent to this business.</p>
20	 <p>Dear Neighbour,</p> <p>The Fiveways are asking for changes to their licence. They want the outside area to be open until 23.00 Monday- Thurs and 1.00 am Friday to Saturday. They want to be able to have live music outside until closing. They also want to show films outside until closing. If you want to raise an objection to this variation in their licence, you must email the council before the <b>15<sup>th</sup> November</b>. You must provide your name and address and your objections under the following categories.</p> <ul style="list-style-type: none"> <li>• preventing crime and disorder</li> <li>• public safety</li> <li>• preventing public nuisance</li> <li>• protecting children from harm</li> </ul> <p>Premises Licence Number BHC084378</p> <p>licensing@bcp.gov.uk</p> <p><i>+ late Noise, as I live very near and like to sleep! I don't do Email</i></p> <p>BCP COUNCIL 13 NOV 2025 Digital Mail Room</p>
21	<p>Dear Sir/Madam.</p> <p>I have lived at ..... since Summer 2010. My Mum &amp; Dad helped me purchase my flat. Approx 5 years later, Mum &amp; Dad were offered first refusal of the upstairs flat. They ....., buy to let - and they've had permanent tenants since. My tenant's upstairs have children.</p> <p>We live on Green Road, a lovely area near a lot of schools. The houses/flats are mainly owned outright by those who are working. There are also a lot of older people in the area who have families and children. There are so many sought after schools in the area.</p> <p>The houses in the local area are very old. Houses on Green road were build in 1907/1908. The pub closed at a decent hour in those times.</p> <p>Everything is usually quiet, until there is a disturbance at the Fiveways - or when good weather/happens - and the noise becomes unbearable in the pub beer garden.</p> <p>There is an issue with ASB/drug dealing at Fampoux Gardens - at various times of the day. This is increased in the summer months - people are going from the Fiveways to the park and back, or meeting cars on Green Road. This issue happens during the day, I only noticed when I was deep cleaning my property, and was stood outside putting refuse sacks into the boot of my car.</p> <p>The floodlighting in the carpark which has a public right of way doesn't work, so there is no protection for members of the public who might walk through there during the night. The surface of the carpark has potholes 3-4 inches deep and regularly floods - making the potholes invisible. These fill with ice/black ice during the winter. The disabled bay in the carpark isn't patrolled by the pub staff, so is abused by those who do not have a blue badge.</p>

	<p>Before providing this statement, I tried telephoning the Fiveways to speak with the General Manager Hayley Connell. Unfortunately, the phone rang out and there was no way to leave a message.</p> <p>In my honest opinion, I feel it's such a shame that locals weren't consulted; let alone informed about their intentions to request an extension of the on licence hours. Especially the fact that they've applied for planning permission, to install TV screens in the garden. I tried to speak with Marston's head office, but there is no public facing telephone number listed.</p> <p>The previous General Manager/Landlady would involve the community. If anything was happening at the pub, or there was a disturbance - she'd be at the end of the telephone. She'd always welcome our feedback and there was positive engagement.</p> <p>My main concerns are:</p> <ul style="list-style-type: none"> <li>• extra noise/asb generated from having the TV's in beer garden. Both the TV's and sound + noise from patrons.</li> <li>• extra noise generated from those going from the bar to the garden to watch the new TV's</li> <li>• change of on licence hours until 0100 on Friday/Saturday night, and 0000 on a Sunday. - Will alcohol be served in the garden until that time? Will there be extra security?</li> <li>• Extra demand on local parking along Green Road.</li> </ul> <p>In Marston's defence they used to discuss issues of noise and ASB. This area manager was amazing back then - they tried bringing the drey's in at 0640am on a Monday morning. Stephanie fixed it.</p> <p>I telephoned Stephanie from Marston's this morning, she didn't seem to be bothered anymore. I asked if I could discuss the proposals, and what it might mean being a neighbour to the pub - no useful answers.</p> <p>My objection is firm.</p> <p>I object to Marston's:</p> <p>Extend hours for supply of alcohol, regulated entertainment and late night refreshment until 01:00 on Friday and Saturday and until 00:00 on Sunday</p> <ul style="list-style-type: none"> <li>• Add films (indoors and outdoors) and indoor sporting events from 10:00 to 00:00 on Sunday to Thursday and 10:00 to 01:00 on Friday and Saturday</li> <li>• Add a condition to further promote the protection of children from harm licensing objective</li> </ul>
22	<p>Morning Sarah,</p> <p>On behalf of Environmental Health, I wish to make a representation regarding the current Fiveways application under the licensing principal of Prevention of Public Nuisance.</p> <p>As you will see from the message below, I am currently in negotiation with Michelle from JG&amp;P and will update you if we reach an agreement.</p>

Kind regards,

Andrew Wemyss  
Environmental Health Officer  
Communities

From: Andrew Wemyss  
Sent: 12 November 2025 07:13  
To: 'Michelle Hazlewood CBII' <  
Cc: Licensing Com <  
Subject: RE: Fiveways, 423 Charminster Road, Bournemouth. BH8 9QY (FIV1/44)

Dear Michelle,

I am pleased that your clients have agreed to reduce the hours which they wish to carry out regulated entertainment. My principal concern, however, remains the proposed outdoor entertainment and how this might be effectively controlled.

At this stage, I would need to review the proposed Noise Management Plan before I can assess whether it is sufficiently comprehensive to address my concerns, or whether the prospect of outdoor entertainment for extended periods each day would still present an issue.

As we are fast approaching the last date for representations, I will make a representation on the grounds of Prevention of Public Nuisance whilst we continue our discussions with the aim of agreeing a way forward.

I would therefore be grateful if you could provide a draft Noise Management Plan setting out in detail how your clients intend to control noise arising from entertainment, customers, and other operational activities, both inside and outside the premises.

I look forward to hearing from you.

Yours sincerely,

Andrew Wemyss  
Environmental Health Officer  
Communities

From: Sue McCourt < > On Behalf Of Michelle Hazlewood CBII  
Sent: 11 November 2025 11:58  
To: Andrew Wemyss  
Cc: Licensing Com <  
Subject: RE: Fiveways, 423 Charminster Road, Bournemouth. BH8 9QY (FIV1/44)

Dear Andrew

Further to our recent communication, I have obtained my clients instructions in connection with the proposed amendments to the application.

	<p>My clients have confirmed that they would be prepared to restrict regulated entertainment and films to 23:00 hours but with a retention of the proposed licensable activity of retail sale of alcohol midweek until 23:00 hours and on Friday and Saturday until 12 midnight.</p> <p>My clients are also agreeable to operation of a Noise Management Plan. Would you require to see the content of the Noise Management Plan before agreement can be achieved or for its existence to be a condition on the Licence?</p> <p>I await to hear from you.</p> <p>Yours sincerely Michelle Hazlewood</p>
--	-------------------------------------------------------------------------------------------------------------------------------------------------------------------------------------------------------------------------------------------------------------------------------------------------------------------------------------------------------------------------------------------------------------------------------------------------------------------------------------------------------------------------------------------------------------------------------------------------------------

This page is intentionally left blank